



Hella marine



World leading lighting technology
Energy saving and ultra durable



www.hellamarine.com



Turn up the party, Select the mood,
Switch on the fish magnets.

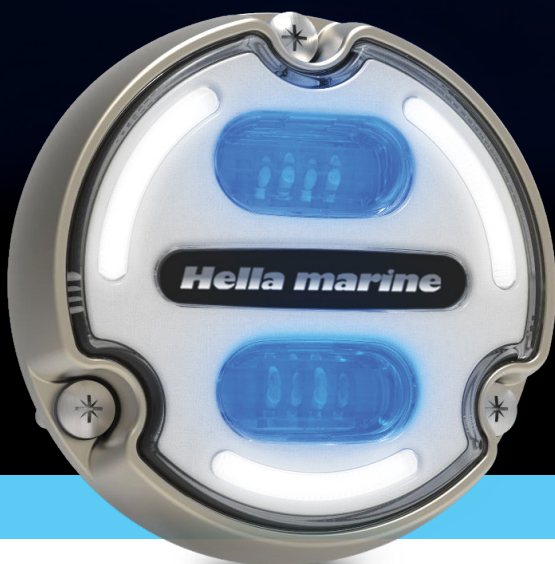

APELO
Underwater Lighting Brilliance



Hella marine



On the water power is often a scarce resource. Long lasting and ultra efficient lighting has a substantial role to play in conserving energy while adding entertainment, style, function and safety.

Welcome to Hella marine, world leading high technology lighting that sets benchmarks for 'Fit and Forget' reliability, and efficiency with outstanding customer service and support.

Founded in 1925 by HELLA in Lippstadt, Germany, Hella marine is now head-quartered in Auckland, New Zealand, a country with a rich maritime history, world class boat building and yacht racing success.

Through ongoing R&D, innovative design and use of high quality materials, Hella marine continues to set benchmarks for extremely reliable and highly efficient products.

Today Hella marine is a globally recognised and trusted brand with LED navigation and high performance lighting systems available in over 60 countries through the global HELLA network and specialist marine distributors.

ISO 9001

BUREAU VERITAS
Certification

Nº 201297



Hella marine is certified to the international quality standard ISO 9001:2008 for:

'The Design and Manufacture of Marine Navigation Lighting, General Lighting, LED Based Lighting and Associated Electronic Control Units. The Design and Manufacture of Automotive Lighting and Signalling Equipment, General Lighting, Optical Products and Plastic Components.'



Hella marine



Get the Hella marine advantages

5 YR
WARRANTY

5 Year Warranty

Peace of mind the product will stand the test of time.

HIGH
CRI

High CRI

A high colour rendering index ensures object and surface colours are replicated naturally.

IP67
COMPLETELY
SEALED

IP67 - Completely Sealed

Preventing moisture from corroding electronics is vital for long term durability. Hella marine products are completely sealed for interior or exterior use, wet or dry.

HD
GRILAMID
LENS

Heavy Duty Grilamid® Lens

A revolutionary transparent plastic with exceptionally high impact strength and resistance to UV and chemical damage.

UV
RESISTANT

Outstanding UV and Impact Resistance

Advanced impact resistant polymers that will not yellow or deteriorate, even after extreme exposure to UV.

LED

Class Leading Efficiency

Combining efficient LED sources with advanced optics, Hella marine delivers more light per watt for significant energy savings. Low heat signatures reduce heat on board and prevent damage to surrounding materials.

EMC

Electromagnetic Compatibility (EMC)

Products that suppress possible interference, emission and susceptibility to emissions, according to international standards. This prevents possible interference with radio, communication, navigation and other electrical equipment on board.



Contents

Apelo Underwater Lighting	6	LED Navigation Lamps	38
EuroLED 95 Down Lights	8	NaviLED Compact	40
EuroLED 75 Down Lights	10	NaviLED Deck Mount	40
EuroLED 130 & 150 Down Lights	12	NaviLED PRO	41
Ponui Reading Lamps	14	NaviLED 360	42
Flexi-Spot Chart Table Lamps	15	NaviLED Trio LED Tri Colour	43
Strip Lamps	16	Submersible LED Trailer Lamps	44
Step Lighting	18	Submersible LED Position Lamps	45
Slim Line Courtesy Lamps	20	Water Resistant Plugs and Sockets	46
DuraLED Utility Lighting	22	Two Speed "Turbo" Fans	47
FMS Low Profile Decklamps	24	Push Button Switches	48
Module 70 Floodlighting	26	2 Group Light Dimmer	49
Sea Hawk Light Bars	28	Battery Master Switches	50
Sea Hawk XL Dual Colour Flood Lights	30	Voltage Sensitive Relay	51
Sea Hawk XLR & R Flood Lights	32	Hella marine Warranty	52
RokLUME Floodlighting	34	Navigation Lamp Approvals	53
HypaLUME Floodlighting	36	IMO COLREG 72 Lights and Visibility	54

Apelo Underwater Lighting



Redefining entertainment lighting



Optical intelligence for superior brightness

Expert optical design delivers more light with a wide horizontal spread and a narrow vertical distribution for high lux levels where it counts instead of sending light too high or too low where it becomes invisible. For the lumen rating on offer, Apelo competes with lamps offering higher lumen ratings using less energy to achieve the same intensity levels.

Advanced materials

Apelo A1 uses a thermal polymer housing, a material completely resistant to corrosion and suitable for any hull material. Hella marine has employed thermal polymers for decades and built-up substantial experience. Thermal polymer draws heat away from the internal electronics to support the brightest polymer underwater lamps on the market.

Electronic protection

Inside every Apelo lamp are intelligent drive circuits that sense their environment to regulate the power and control the heat inside. Apelo is as happy running out of the water as in it. We call this dry running protected.

Sealing confidence

Robotic gluing delivers an incredible sealing accuracy of the glue mix and pinpoint placement batch after batch with near infinite repeatability. For confidence, Apelo is certified to IP68 and IP69.

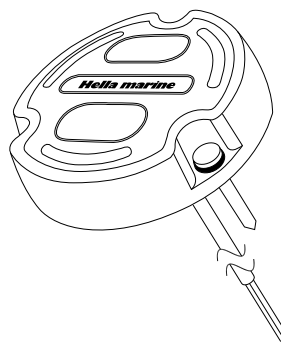

Robust Surface Mount

High strength mounting system. Fastenings included.



Edge Light Technology

Apelo A2 showcases Edge Light, distinctive glowing signatures of elegant illumination bordering the lamp front.



Optical Intelligence

Apelo lamps project a wide horizontal spread of colour across the water with spectacular effect. Asymmetric light patterns focus light efficiently below the waterline.



Dry Running Protected

Advanced thermal management ensuring ongoing protection and no damage by operation out of the water.



Lightspeed™ Recommended

Hella marine recommends Lightspeed™ by Propspeed®, a foul-release coating to protect Apelo underwater lights and maintain their underwater brilliance. Lightspeed™ is tested to provide no decrease in light intensity, no colour shift and no other adverse performance decreases.

Apelo A1 Underwater Light - 1800 Lumen

For all hull materials.

Lumen	1800 (White)	
Lens Material	Heavy duty Grilamid®	
Base Material	Corrosion proof thermal polymer	
Colour Temperature	5000K (White)	
Pre-wired Cable	2.5m / 8.2ft, marine cable	
Operating Voltage	Multivolt™ 9-32V DC, 12/24V DC Nominal	
Power Consumption	White / Blue 20W / 1.7A @ 12V, 0.9A @ 24V RGB 15W / 1.25A @ 12V, 0.7A @ 24V	
Protection	IP68 / IP69	
Weight (incl. cable)	White / Blue 250g	RGB 300g
Approvals	EN55015 / CISPR 15, IEC60533, IEC61547, ICES-5	

Light Colour	White Lens	Charcoal Lens
White / Blue	2LT 016 145-011	2LT 016 145-001
RGB	2LT 016 146-011	2LT 016 146-001

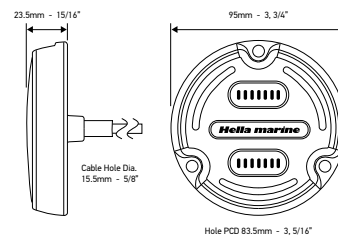

White / Blue



RGB



Apelo A2 Underwater Light Bronze - 3000 Lumen

For all hull materials. (Not aluminium)

Lumen	3000 (White)	
Lens Material	Heavy duty Grilamid®	
Base Material	Marine grade bronze	
Colour Temperature	5000K (White)	
Pre-wired Cable	2.5m / 8.2ft, marine cable	
Operating Voltage	Multivolt™ 9-32V DC, 12/24V DC Nominal	
Power Consumption	White / Blue 30W / 2.5A @ 12V, 1.3A @ 24V RGB 30W / 2.5A @ 12V, 1.3A @ 24V Edge Light <2W / <0.2A @ 12V, <0.1A @ 24V	
Protection	IP68 / IP69	
Weight (incl. cable)	White / Blue 600g	RGB 650g
Approvals	EN55015 / CISPR 15, IEC60533, IEC61547, ICES-5	

Light Colour	White Lens
White / Blue	2LT 016 147-101
RGB	2LT 016 148-101

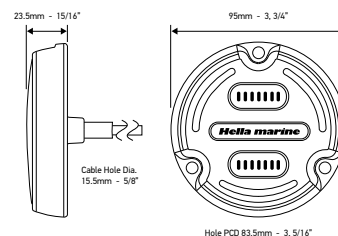

White / Blue



RGB



Edge Light



Apelo A2 Underwater Light Aluminum - 3000 Lumen

For aluminium hulls and vessels not permanently submerged.

Lumen	3000 (White)	
Lens Material	Heavy duty Grilamid®	
Base Material	Hard Anodised Aluminium	
Colour Temperature	5000K (White)	
Pre-wired Cable	2.5m / 8.2ft, marine cable	
Operating Voltage	Multivolt™ 9-32V DC, 12/24V DC Nominal	
Power Consumption	White / Blue 30W / 2.5A @ 12V, 1.3A @ 24V RGB 30W / 2.5A @ 12V, 1.3A @ 24V Edge Light <2W / <0.2A @ 12V, <0.1A @ 24V	
Protection	IP68 / IP69	
Weight (incl. cable)	White / Blue 310g	RGB 360g
Approvals	EN55015 / CISPR 15, IEC60533, IEC61547, ICES-5	

Light Colour	Charcoal Lens
White / Blue	2LT 016 147-001
RGB	2LT 016 148-001

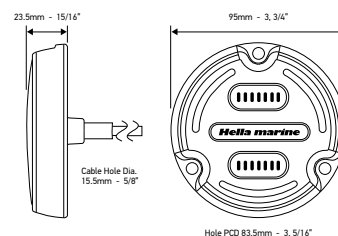

White / Blue



RGB



Edge Light



EuroLED 95 Down Lights



Style, functionality, performance, energy efficiency and long-lasting illumination, EuroLED 95 lighting is an elegant addition to any vessel.

The smooth diffused lens creates a comfortable and uniform appearance, while high output LEDs produce over 420 lumen of broad and even illumination.

The ultimate in versatility, with a choice of light temperature between 5000K white – best for enhanced brightness in working conditions to 2700K warm white – creating a cosy atmosphere and bringing out the best in wooden furniture.

A high colour rendering index of 85+ (CRI) also ensures object and surface colours are replicated naturally. Optional red and blue secondary LED colours also add increased functionality.



EuroLED 95 Down Light - Spring Mount

Power Consumption	<6W (<0.05A@12V / <0.25A@24V)
Lumen	420 lumen
Beam Angle / CRI	90° / 85 CRI
Operating Voltage	Multivolt™ 9-33V DC
Protection	IP6K9K (Completely sealed) IP67
Rim Material	Highly Polished 316 Stainless Steel
Cable	Pre-wired with 120mm marine cable
Colour Temperature	5000K (White) , 2700K (Warm White)
Dimming	Via PWM

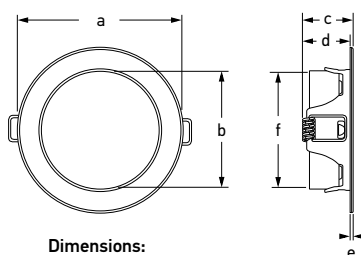

Dimensions:
a = 95.0mm (3.7")
b = 68.0mm (2.7")
c = 30.0mm (1.2")
d = 27.3mm (1.07")
e = 2.0mm (0.08")
f = 72.0mm (2.83") (Mounting Hole)

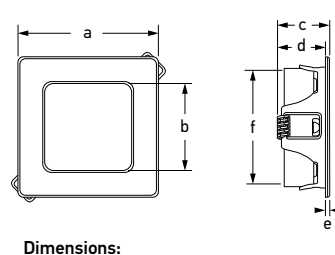

Dimensions:
a = 78.0mm (3.1")
b = 48.0mm (1.9")
c = 29.0mm (1.14")
d = 26.4mm (1.04")
e = 2.5mm (0.1")
f = 72.0mm (2.83") (Mounting Hole)

Round Lamps

Light Colour	Mounting	Round polished stainless steel rim
White / Red	Spring	2JA 958 340-101
Warm White / Red	Spring	2JA 958 340-121
White / Blue	Spring	2JA 958 340-111
Warm White / Blue	Spring	2JA 958 340-131
White	Spring	2JA 958 340-011
Warm White	Spring	2JA 958 340-021

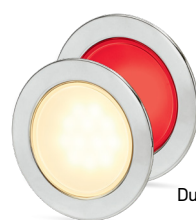

Dual Colour



Single Colour

Square Lamps

Light Colour	Mounting	Square polished stainless steel rim
White / Red	Spring	2JA 958 340-601
Warm White / Red	Spring	2JA 958 340-621
White / Blue	Spring	2JA 958 340-611
Warm White / Blue	Spring	2JA 958 340-631
White	Spring	2JA 958 340-511
Warm White	Spring	2JA 958 340-521



Dual Colour



Single Colour

EuroLED 95 Down Light - Screw Mount

Power Consumption	<6W (<0.05A@12V / <0.25A@24V)
Lumen	420 lumen
Beam Angle / CRI	90° / 85 CRI
Operating Voltage	Multivolt™ 9-33V DC
Protection	IP6K9K (Completely sealed) IP67
Rim Material	Polished 316 Stainless Steel / White
Cable	Pre-wired with 120mm marine cable
Colour Temperature	5000K (White) , 2700K (Warm White)
Dimming	Via PWM

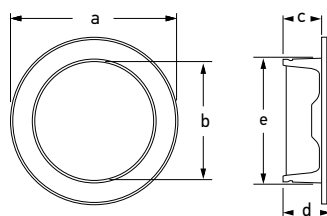

White Rim
a = 96.2mm (3.8")
b = 68mm (2.7")
c = 22.2mm (0.9")
d = 27.7mm (1.09")
e = 72mm (2.83")

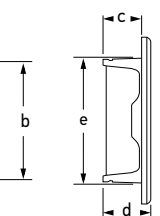

Stainless Steel Rim
a = 95mm (3.74")
b = 68mm (2.7")
c = 22.2mm (0.9")
d = 27.1mm (1.07")
e = 72mm (2.83")

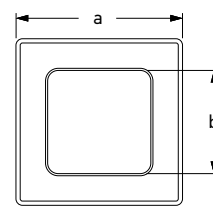

White Rim
a = 80mm (3.15")
b = 48.0mm (1.85")
c = 22.2mm (0.9")
d = 27.7mm (1.09")
e = 72mm (2.83")

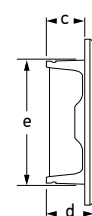

Stainless Steel Rim
a = 79mm (3.11")
b = 48.0mm (1.9")
c = 22.2mm (0.9")
d = 27.3mm (1.07")
e = 72mm (2.83")

Round Lamps

Light Colour	Mounting	White rim	Polished stainless steel rim
White / Red	Screw	2JA 958 340-061	2JA 958 340-161
White / Blue	Screw	2JA 958 340-081	2JA 958 340-181
Warm White / Red	Screw	2JA 958 340-071	2JA 958 340-171
Warm White / Blue	Screw	2JA 958 340-091	2JA 958 340-191

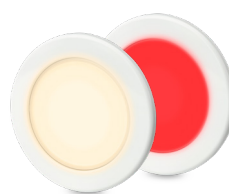

White Rim



Polished Stainless Steel Rim

Square Lamps

Light Colour	Mounting	White rim	Polished stainless steel rim
White / Red	Screw	2JA 958 340-561	2JA 958 340-661
White / Blue	Screw	2JA 958 340-581	2JA 958 340-681
Warm White / Red	Screw	2JA 958 340-571	2JA 958 340-671
Warm White / Blue	Screw	2JA 958 340-591	2JA 958 340-691



EuroLED 75 Down Lights



Stylish and energy efficient LED down lights for interior and exterior applications with a single or dual colour function.



Leading LED technology delivers exceptional colour rendering, reproducing colours in their natural richness. Producing an impressive output of 190 actual lumens, with a diffused lens, creates a bright, broad and even illumination, replicating the pleasing appearance of a traditional round lamp.

Suitable for interior and exterior applications, wet or dry, EuroLED 75 lamps are completely sealed - IP67 rated. Manufactured using high-grade materials these lamps will not corrode, fade or embrittle in the harsh marine environment.

Warm white EuroLED 75 with one EuroLED 75 dual colour (red) above the helm.



EuroLED 75 Dual Colour

Power Consumption	3W (<0.19A @ 12V DC)
Lumen	190 lumen
Beam Angle / CRI	80° / 85 CRI
Operating Voltage	12V DC (9-16VDC)
Protection	IP6K7 & IP6K9K (Completely sealed)
Rim material	UV resistant plastic or 316 stainless steel
Cable	Pre-wired with 120mm marine cable
Colour Temperature	5000K (White) , 2700K (Warm White)
Dimming	Via PWM or Voltage Resistive dimmer

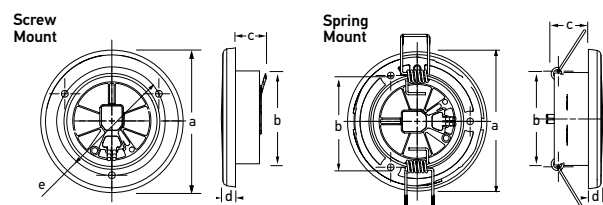

Dimensions:

a = 72.0mm (2.83") with stainless rim	c = 16.0mm (0.63") with screw mounting
75.0mm (2.95") with plastic rim	20.5mm (0.81") with spring mounting
b = 50.0mm (1.96") with screw mounting	d = 7.5mm (0.29")
54.0mm (2.12") with spring mounting	e = 57.0mm (2.24") PCD

Round Lamps

Light Colour	Voltage	Mount Type	White Plastic Rim	Stainless Steel Rim
Red / White	12V	Screw	2JA 015 247-011	2JA 015 247-021
Red / Warm White	12V	Screw	2JA 015 247-111	2JA 015 247-121
Red / White	12V	Spring Clip	2JA 015 247-511	2JA 015 247-521
Red / Warm White	12V	Spring Clip	2JA 015 247-611	2JA 015 247-621



EuroLED 75 Single Colour

Power Consumption	3W (<0.19A @ 12V DC)
Lumen	190 lumen
Beam Angle / CRI	80° / 85 CRI
Operating Voltage	12V DC (9-16VDC)
Protection	IP6K7 & IP6K9K (Completely sealed)
Rim material	UV resistant plastic or 316 stainless steel
Cable	Pre-wired with 120mm marine cable
Colour Temperature	5000K (White) , 2700K (Warm White)
Dimming	Via PWM or Voltage Resistive dimmer

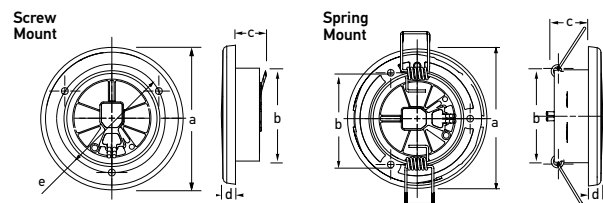

Dimensions:

a = 72.0mm (2.83") with stainless rim	c = 16.0mm (0.63") with screw mounting
75.0mm (2.95") with plastic rim	20.5mm (0.81") with spring mounting
b = 50.0mm (1.96") with screw mounting	d = 7.5mm (0.29")
54.0mm (2.12") with spring mounting	e = 57.0mm (2.24") PCD

Round Lamps

Light Colour	Voltage	Mounting	White Plastic Rim	Stainless Steel Rim
White	12V	Screw	2JA 958 110-011	2JA 958 110-021
White	24V	Screw	2JA 958 110-111	2JA 958 110-121
Warm White	12V	Screw	2JA 958 109-011	2JA 958 109-021
Warm White	24V	Screw	2JA 958 109-111	2JA 958 109-121
White	12V	Spring	2JA 958 110-511	2JA 958 110-521
White	24V	Spring	2JA 958 110-611	2JA 958 110-621
Warm White	12V	Spring	2JA 958 109-511	2JA 958 109-521
Warm White	24V	Spring	2JA 958 109-611	2JA 958 109-621



Square Lamps

Light Colour	Voltage	Mounting	White Plastic Rim	Chrome Plastic Rim
White	12V	Screw	2JA 015 014-011	2JA 015 014-021
White	24V	Screw	2JA 015 014-111	2JA 015 014-131
Warm White	12V	Screw	2JA 015 014-211	2JA 015 014-221
Warm White	24V	Screw	2JA 015 014-311	2JA 015 014-321



EuroLED 130 & 150 Down Lights



Hella marine touch technology makes lighting control beautifully simple.



Touch the red pad for red light, the white pad for white light. Hold a finger on the pad for two seconds and the lamp will cycle through increasing / decreasing intensity levels. Release at the intensity level required.

Dual colour EuroLED lamps may also be remotely operated from multiple points via momentary switches. Holding an external switch for two seconds will synchronise the lamps to the same colour and /or intensity level.

Light levels are stored by the lamps circuitry, even when a vessel's batteries are turned off. The lamp will turn on at the colour intensity previously set, regardless of power interruption.



EuroLED 130 Lamps

Lens material	UV resistant enhanced impact acrylic
Shroud material	Heavy duty nylon
Colour Temperature	5000K (White)
Cable	Pre-wired with 2.5m of marine cable
Operating Voltage	Multivolt™ 9-33V DC
Power Consumption	4.0W (0.33A@12V / 0.17A@24V)
Protection	IP 67 (Completely Sealed)
Approvals	ISO 8846 (Ignition Protection)

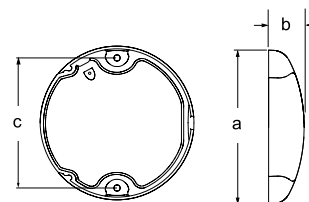

Dimensions
a = 129.5mm / 5.10"
b = 29.5mm / 1.16"
c = 110mm / 4.33"

Dual Colour EuroLED Touch 130 Lamps

Light Colour	White shroud	Black shroud
White / Red	2JA 959 950-121	2JA 959 950-111
White / Blue	2JA 959 951-121	2JA 959 951-111



Single Colour EuroLED Touch 130 Lamps

Light Colour	White shroud	Black shroud
White	2JA 959 950-521	2JA 959 950-511



EuroLED 130 Spacer Rings
Black 8HG 959 952-002
White 8HG 959 952-012

Single Colour EuroLED 130 Lamps (no switching)

Light Colour	White shroud	Black shroud
White	2JA 959 820-521	2JA 959 820-511



EuroLED 130 Shroud
Black 9HD 959 027-002
White 9HD 959 027-012

EuroLED 150 Lamps

Lens material	UV resistant enhanced impact acrylic
Rim material	UV resistant plastic. 316 stainless steel
Colour Temperature	5000K (White) 3000K (Warm White)
Cable	Pre-wired with 500mm of marine cable
Operating Voltage	Multivolt™ 9-33V DC
Power Consumption	4.0W (0.33A@12V / 0.17A@24V)
Protection	IP 67 (Completely Sealed)

Note - A white spacer ring is included with each EuroLED 150

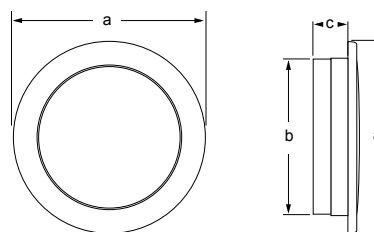

Dimensions
a = 150 mm / 5.90"
b = 124 mm / 4.88"
c = 20 mm / 0.79"

Dual Colour EuroLED Touch 150 Lamps

Light Colour	White plastic rim	Stainless steel rim
White / Red	2JA 980 630-001	2JA 980 630-011
Warm White / Red	2JA 980 630-101	2JA 980 630-111
White / Blue	2JA 980 630-201	2JA 980 630-211



Single Colour EuroLED Touch 150 Lamps

Light Colour	White plastic rim	Stainless steel rim
White	2JA 980 630-501	2JA 980 630-511
Warm White	2JA 980 630-601	2JA 980 630-611



Single Colour EuroLED 150 Lamps (no switching)

Light Colour	White plastic rim	Stainless steel rim
White	2JA 980 631-501	2JA 980 631-511
Warm White	2JA 980 631-601	2JA 980 631-611



Ponui Reading Lamps



Timeless polished chrome housings combine with energy efficient LED technology in a range of attractive and 'cool to touch' reading lamps with switches.

Hella marine optics provide a uniform distribution of light without glare or eye strain.

The light colour exactly matches an equivalent Hella marine EuroLED 75 and EuroLED 95 for consistent illumination and coordinated ambience throughout a vessel.

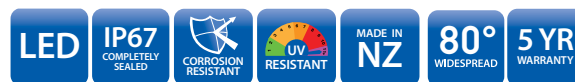

Power Consumption	3W (<0.19A @ 12V DC)	
Lumen	190	
Beam Angle / CRI	80° / 85 CRI	
Operating Voltage	12V or 24V DC	
Protection	IP6K7 & IP6K9K (Completely sealed)	
Lens Material	UV resistant enhanced impact acrylic	
Lamp Body Material	Bright chrome plated brass	
Cable	Pre-wired with 120mm marine cable	
Colour Temperature	5000K (White) , 2700K (Warm White)	
Dimming	Via PWM or Voltage Resistive dimmer	

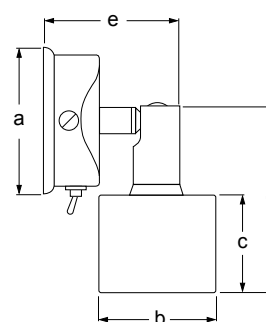

Dimensions:

a = 70 mm / 2.76"
b = 55 mm / 2.17"
c = 36 mm / 1.42"
d = 75 mm / 2.95"
e = 65 mm / 2.56"

Light Colour	12V	24V
White	2JA 958 358-001	2JA 958 358-201
Warm White	2JA 958 358-011	2JA 958 358-211

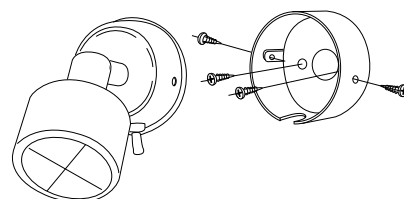

- Bulkhead mount via plastic mounting cup
- Lamp is pre-wired with marine cable

Flexi-Spot Chart Table Lamps



Energy efficient lamps for a variety of interior applications including chart table and navigation area lighting, berth lighting and adjustable reading lights.



Available in single red or white LED light or dual colour red and white LED versions with integrated dimming via a rotary switch built into the head.

Housing Description	UV and impact resistant plastic
Arm material	Single colour - Coated steel arm Dual colour red / white - 316 stainless arm
Cable	Pre-wired with 120mm of cable
Operating Voltage	Multivolt™ 9-31V DC
Power Consumption	<2W (<0.16A@12V / <0.08A@24V)
Protection	IP 53
Weight	150mm - 130g (including cable) 400mm - 230g (including cable)

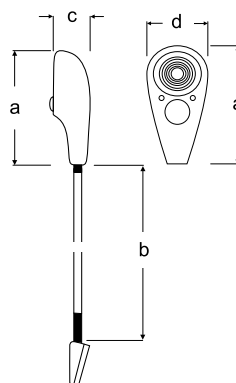

Dimensions

a = 104mm / 4.09"
b = 150mm / 5.91"
400mm / 15.75"
c = 36mm / 1.42"
d = 46mm / 1.81"

Light Colour	150mm Shaft	400mm Shaft
White / Red	2JA 343 720-522	2JA 343 720-622
White	2JA 346 720-022	2JA 346 720-122
Red	2JA 346 720-052	2JA 343 720-152



Dual colour LED chart table lamps feature a rotary dial for on / off and red / white light control and dimming.

Strip Lamps



Featuring an innovative waterproof switch, Hella marine strip lamps offer an ultra-low profile design and are completely sealed for interior and exterior installations.

Combining impressive light performance and low energy consumption, strip lamps are ideal to replace bulky fluorescent lighting. With 250 lumens (White) and a high CRI rating of 85 these elegant fittings enhance with bright and accurate illumination.

The sealed switch prevents moisture entering the electronics, while the low profile design offers an effortless installation almost anywhere on board. Fastenings at each end of the lamp body are covered by snap-on end caps for a modern appearance.

Purpose designed for the harsh marine environment, surface mount strip lamps are salt water durable and ideal for interior and exterior, wet or dry applications.



8HG 958 000-011
45° Mounting Bracket White

8HG 958 000-021
45° Mounting Bracket Charcoal

9HD 958 108-831
Charcoal Switch Caps

9HD 958 108-811
Charcoal Dual Switch Caps

Surface Mount Interior Lamps

Lens Material	UV resistant enhanced impact acrylic
Colour Temperature	5000K (White) 2700K (Warm White)
Dimming	Hella marine Dimmer 5XA 998 572-001
Cable	Pre-wired with 500mm of marine cable
Operating Voltage	9-16V DC / 18-32V DC
Power Consumption	White <3.0W (<0.25A@12V / <0.16A@24V)
Protection	IP 67 (Completely Sealed)
Weight	75g (including cable)

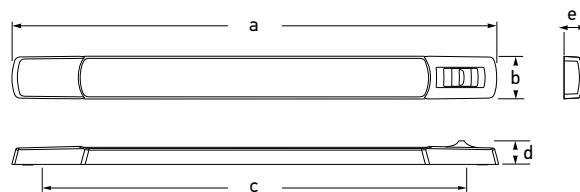

Dimensions:

a = 283mm	(11.14")
b = 25mm	(1.0")
c = 265mm	(10.43")
d = 14mm	(0.55") Switch Cap
e = 11mm	(0.43") Plain Cap

Surface mount strip lamps with switches

Light Colour	12V	24V
White	2JA 958 123-001	2JA 958 123-401
White / Red	2JA 958 121-001	2JA 958 121-401
White / Blue	2JA 958 121-011	2JA 958 121-411
Warm White	2JA 958 123-101	2JA 958 123-501
Warm White / Red	2JA 958 121-101	2JA 958 121-501
Warm White / Blue	2JA 958 121-111	2JA 958 121-511



Surface mount strip lamps - Non switched

Light Colour	12V	24V
White	2JA 958 124-001	2JA 958 124-401
Warm White	2JA 958 124-101	2JA 958 124-501



Surface Mount Courtesy Intensity Strip Lamps

Lens Material	UV resistant enhanced impact acrylic
Colour Temperature	5000K (White) 2700K (Warm White)
Dimming	Hella marine Dimmer 5XA 998 572-001
Cable	Pre-wired with 500mm of marine cable
Operating Voltage	12V DC or 24V DC
Power Consumption	White 1.5W (0.13A@12V / 0.06A@24V)
Protection	IP 67 (Completely Sealed)
Weight	75g (including cable)

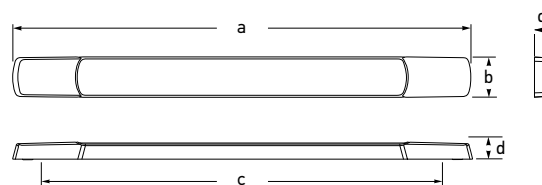

Dimensions:

a = 283mm	(11.14")
b = 25mm	(1.0")
c = 265mm	(10.43")
d = 11mm	(0.43")

Surface mount courtesy intensity strip lamps - Non switched

Light Colour	12V	24V
White	2JA 980 881-012	2JA 980 881-112
Warm White	2JA 980 881-212	2JA 980 881-312
Blue	2JA 980 881-402	2JA 980 881-502
Red	2JA 980 881-602	2JA 980 881-702

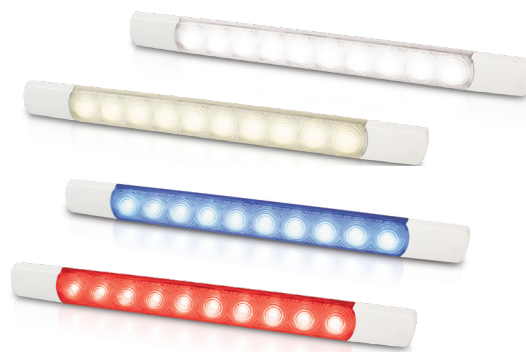

Step Lighting



Attractive, compact and energy efficient LED courtesy lighting for interior and exterior applications.



Light is radiated downward at an angle of 30° making these lamps ideal for safely illuminating on board areas such as steps, stairs, toe kicks, storage areas, companion ways, deck fittings, signs and switches.

Hella marine step lamps are completely sealed, shock and vibration resistant and represent reliable 'fit and forget' technology. Multivolt™ electronics ensure constant light output in 12V or 24V DC systems.

Each lamp is pre-wired with marine cable and supplied with stainless steel screws.



Easy Fit Step Lamps

Lens Material	UV resistant enhanced impact acrylic
Cap Material	White plastic, chrome plated plastic, polished 316 stainless
Cable	Pre-wired with 100mm of marine cable
Operating Voltage	Multivolt™ 9-32V DC
Power Consumption	0.5W (<0.04A@12V / <0.02A@24V)
Protection	IP 67 (Completely Sealed)
Weight	Stainless Cap - 30g (including cable) Plastic Cap - 15g (including cable)

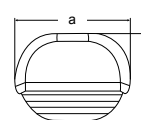
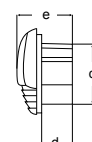

Dimensions
a = 45mm / 1.77"
b = 31.5mm / 1.24"
c = 25.4mm / 1.00"
d = 14mm / 0.55"
e = 22.7mm / 0.89"



Light Colour	Chrome Plated Cap	White Plastic Cap	Stainless Steel Cap
White	2JA 958 126-001	2JA 958 126-011	2JA 958 126-031
Warm White	2JA 958 126-401	2JA 958 126-411	2JA 958 126-431
Blue	2JA 958 126-101	2JA 958 126-111	2JA 958 126-131
Red	2JA 958 126-201	2JA 958 126-211	2JA 958 126-231

Surface Mount Oblong Courtesy Lamps

Lens Material	UV resistant enhanced impact Grilamid®
Cap Material	316 stainless steel
Cable	Pre-wired with 120mm of marine cable
Operating Voltage	Multivolt™ 12 / 24V DC
Power Consumption	0.5W (<0.04A@12V / <0.02A@24V)
Protection	IP 67 (Completely Sealed)
Weight	35g (including cable)

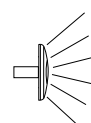
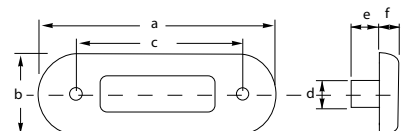

Courtesy light pattern

Dimensions
a = 84 mm / 3.31"
b = 29 mm / 1.14"
c = 58 mm / 2.28"
d = 10 mm / 0.39" Ø
e = 10 mm / 0.39"
f = 9 mm / 0.35"

Light Colour	Polished Stainless Steel Cap
White	2XT 980 869-301
Warm White	2XT 980 869-401
Blue	2XT 980 869-601
Red	2XT 980 869-501



Flush Mount Oblong Step Lamps

Lens Material	UV and impact resistant plastic
Cap Material	316 Stainless Steel
Cable	Pre-wired with 120mm of marine cable
Operating Voltage	Multivolt™ 12 / 24V DC
Power Consumption	0.5W (<0.04A@12V / <0.02A@24V)
Protection	IP 67 (Completely Sealed)
Weight	35g (including cable)

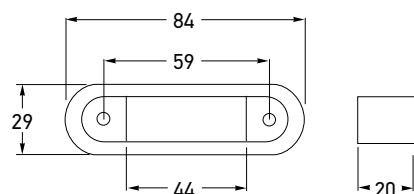

30° Step light pattern

Light Colour	Polished Stainless Cap	Satin Stainless Cap
White	2XT 959 680-811	2XT 959 680-851
Warm White	2XT 959 680-411	2XT 959 680-431
Blue	2XT 959 680-611	2XT 959 680-811
Red	2XT 959 680-711	2XT 959 680-731



Slim Line Courtesy Lighting



Energy efficient Slim Line courtesy lamps can be installed almost anywhere on board.



Advanced lens technology provides a uniform spread of soft light without glare or eye strain. Each lamp is completely sealed, highly shock, impact and vibration resistant, perfectly suited for the demanding marine environment.

Hella marine courtesy lamps feature an ultra low energy consumption of less than 0.5W (less than 0.04A@12V). This provides safer installation into light weight materials where the heat of incandescent lamps may cause damage to the surrounding structure.



Round Slim Line Lamps

Lens Material	UV resistant enhanced impact acrylic
Rim Material	UV resistant plastic. 316 stainless steel
Dimming	Hella marine Dimmer 5XA 998 572-001
Cable	Pre-wired with 120mm of marine cable
Operating Voltage	12V DC or 24V DC
Power Consumption	<0.5W (<0.04A@12V / <0.02A@24V)
Protection	IP 67 (Completely Sealed)
Mounting	Stainless steel screws included

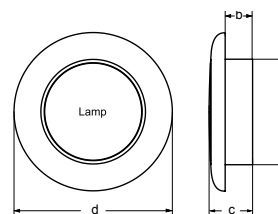

Dimensions

a = 50.0 mm / 1.97"
 b = 13.0 mm / 0.51"
 c = 21.0 mm / 0.83"
 d = 75.0 mm / 2.95" with plastic rim
 72.0 mm / 2.83" with stainless steel rim

White Light Round Lamps*

Rim Finish	12V	24V
Polished stainless rim	2XT 980 500-521	2XT 980 501-521
White plastic rim	2XT 980 500-541	2XT 980 501-541

*Includes a surface mounting spacer ring and stainless steel screws.

Warm White Round Lamps*

Rim Finish	12V	24V
Polished stainless rim	2XT 980 500-721	2XT 980 501-721
White plastic rim	2XT 980 500-741	2XT 980 501-741

*Includes a surface mounting spacer ring and stainless steel screws.

Blue Light Round Lamps

Rim Finish	12V	24V
Polished stainless rim	2XT 980 502-221	2XT 980 503-221
White plastic rim	2XT 980 502-241	2XT 980 503-241

Red Light Round Lamps

Rim Finish	12V	24V
Polished stainless rim	2XT 980 507-221	2XT 980 508-221
White plastic rim	2XT 980 507-241	2XT 980 508-241

Square Slim Line Lamps

Lens Material	UV resistant enhanced impact acrylic
Rim Material	UV resistant plastic. 316 stainless steel
Dimming	Hella marine Dimmer 5XA 998 572-001
Cable	Pre-wired with 120mm of marine cable
Operating Voltage	12V DC or 24V DC
Power Consumption	<0.5W (<0.04A@12V / <0.02A@24V)
Protection	IP 67 (Completely Sealed)
Mounting	Stainless steel screws included

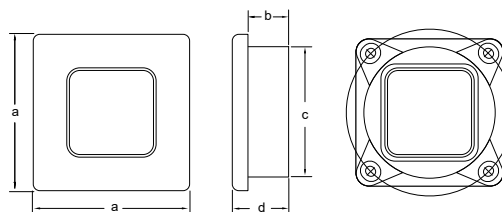

PCD = 63.5mm /

Dimensions

a = 60.0 mm / 2.36"
 b = 16.0 mm / 0.63"
 c = ø50.0 mm / ø1.97"
 d = 22.0mm / 0.87"

White Light Square Lamps*

Rim Finish	12V	24V
Chrome plated rim	2XT 980 580-571	2XT 980 581-571
White plastic rim	2XT 980 580-551	2XT 980 581-551

*Includes a surface mounting spacer ring and stainless steel screws.

Warm White Light Square Lamps*

Rim Finish	12V	24V
Chrome plated rim	2XT 980 580-771	2XT 980 581-771
White plastic rim	2XT 980 580-751	2XT 980 581-751

*Includes a surface mounting spacer ring and stainless steel screws.

Blue Light Square Lamps

Rim Finish	12V	24V
Chrome plated rim	2XT 980 582-271	2XT 980 583-271
White plastic rim	2XT 980 582-251	2XT 980 583-251

Red Light Square Lamps

Rim Finish	12V	24V
Chrome plated rim	2XT 980 587-271	2XT 980 588-271
White plastic rim	2XT 980 587-251	2XT 980 588-251

DuraLED Utility Lighting

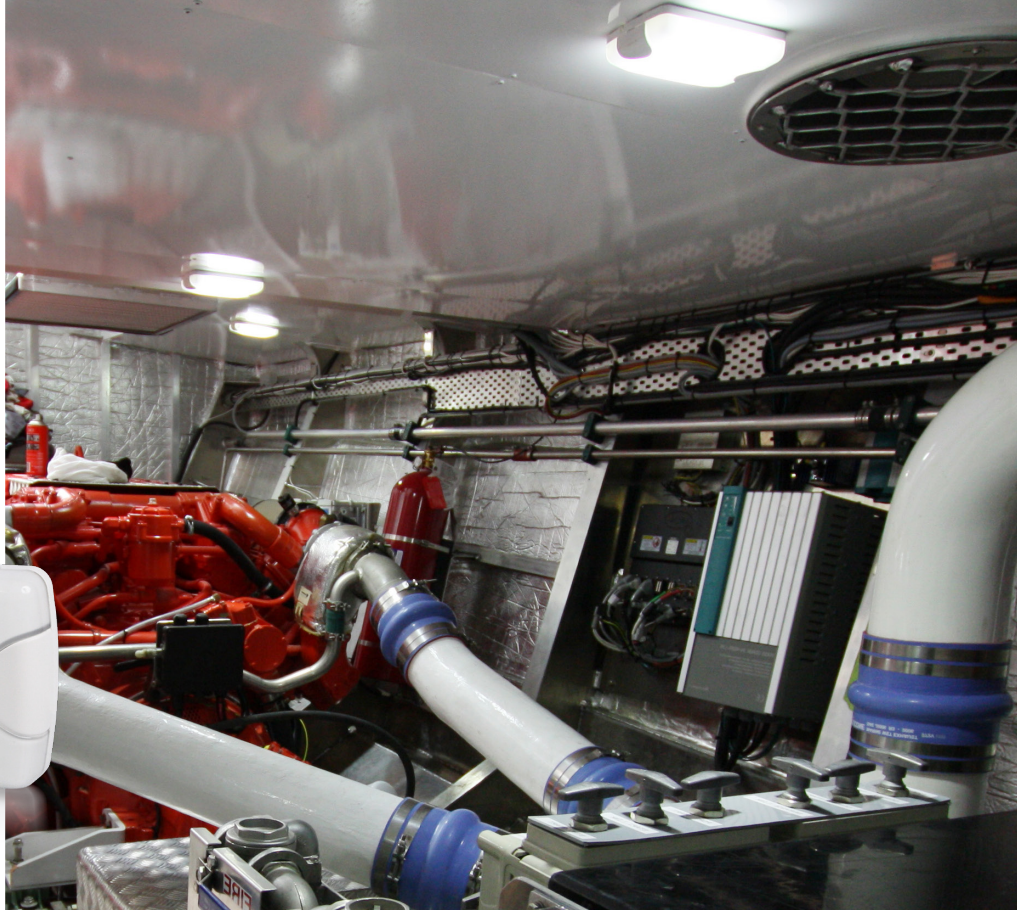

DuraLED lamps are purpose designed for engine rooms and other heavy duty applications where reliability must not be compromised.



DuraLED lamps feature precision optics to disperse light in a very wide spread illumination without glare under decks and low vertical spaces.

Multivolt™ circuitry provides constant illumination and circuit protection on 12 or 24 volt DC systems, even under severe voltage fluctuations. Spike protection, reverse polarity protection and over-voltage protection are all built-in benefits of the sophisticated electronics inside.

The fastening load is taken up by a heavy duty nylon bush to eliminate possible stress on the lamp housing.

DuraLED 50LP is ISO Ignition Protected for safe and certified installation near flammable gas sources.

Lamp Type	DuraLED 12	DuraLED 20	DuraLED 36	DuraLED 50 LP	DuraLED 50 Red / White
Lux @1m	56 Lux	350 Lux	450 Lux	Spread 1650 Lux Wide Spread 375 Lux	660 Lux
Light Angle	120°	64°		Spread 36° Wide Spread 100°	64°
Colour Temperature	5000 K (White)				
Material Description	UV resistant enhanced impact acrylic				
Pre-wired Cable Length	500mm	2.5M			
Operating Voltage	9-33V DC				
Power Consumption	<2.5W (<0.20A@12V)	<4W (<0.33A@12V)	<7W (<0.51A@12V)	12W (0.10A@12V)	<10W (<0.8A@12V)
Weight (including cable)	115g	345g		450g	450g
Operating Temperature	-40°C to +60°C / -40°F to 140°F				
Protection	IP67 (Completely Sealed)				
Approvals	CE, ISO 8846 (Ignition Protection)				

DuraLED 12

Power Consumption	2.5W
Lux @ 1m	56
Beam Angle	120°

Light Colour	Switch	Non Switch
White	2JA 980 704-001	2JA 959 700-101



Dimensions
a = 140mm / 5.51"
b = 65.0mm / 2.56"
c = 32.0mm / 1.26"

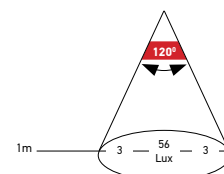
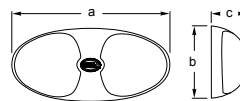

5000 K - 12 LED

DuraLED 20

Power Consumption	4W
Lux @ 1m	350
Beam Angle	60°

Light Colour	Spread lens
White	2JA 980 608-001



Dimensions
a = 177mm / 6.97"
b = 100mm / 3.94"
c = 30.0mm / 1.18"
d = 148mm / 5.83"

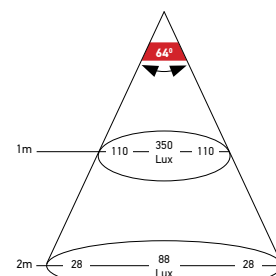
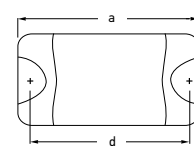

5000 K - 20 LED

DuraLED 36

Power Consumption	7W
Lux @ 1m	450
Beam Angle	62°

Light Colour	Spread lens
White	2JA 959 037-521



Dimensions
a = 177mm / 6.97"
b = 100mm / 3.94"
c = 30.0mm / 1.18"
d = 148mm / 5.83"

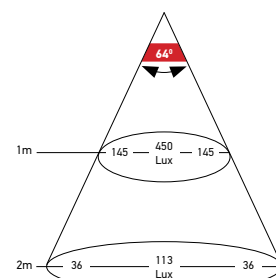
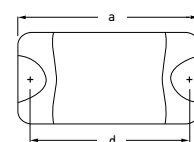

5000 K - 36 LED

DuraLED 50 Low Profile (LP)

Power Consumption	12W (White)
Lux @ 1m	Spread: 1650 Lux Wide Spread: 375 Lux
Beam Angle	Spread: 36° Wide: 100°

Light Colour	Spread lens	Wide Spread lens
White	2JA 980 629-001	2JA 980 629-501
Blue	2JA 980 629-111	

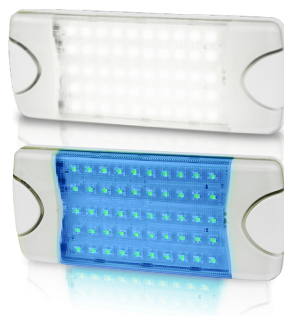

Dimensions:
a = 222mm / 8.74"
b = 96mm / 3.78"
c = 25mm / 0.98"
d = 193mm / 7.60"

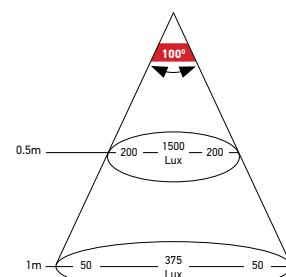
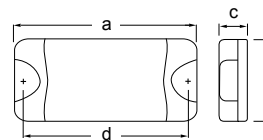

5000 K - 50 LED
Wide Spread

DuraLED 50 Red / White

Power Consumption	10W (White)
-------------------	-------------

Light Colour	Spread lens
White / Red	2JA 980 604-061

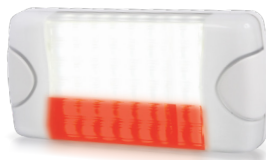

Dimensions:
a = 222mm / 8.74"
b = 96mm / 3.78"
c = 31mm / 1.22"
d = 193mm / 7.60"

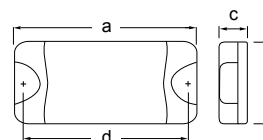

FMS Low Profile Decklamps



FMS low profile and powerful LED decklamps for integrated installations above side decks, along superstructures and more.



Hella marine introduces the FMS, low profile, compact, yet powerful lamps purpose designed to integrate discretely into tight spaces and exterior recesses. With a protrusion of only 38mm (1 1/2 inches) the FMS is sleek and unobtrusive.

Two light intensities are offered, FMS1200 with 1200 lumen, and the FMS2500 with a powerful 2500 lumens of even, close-range illumination directly underneath the lamp.

Hella marine LED technology is the answer for energy efficient, completely sealed, shock and vibration resistant lighting. Advanced electronics provide consistent illumination and circuit protection across a range of inputs from 9-32V DC for an ultra long service life.



FMS Decklamps

Housing Material	Die-cast aluminum, CoroSafe coating
Mounting	Surface mount
Lumen	FMS1200: 1200 lumen FMS2500: 2500 lumen
Colour Temperature	6500K (White)
Cable	Pre-wired with 500mm cable
Operating Voltage	Multivolt™ 12/24V DC (9-32V DC)
Power Consumption	FMS1200: 14W (1.17A@12V DC / 0.58A@24V DC) FMS2500: 28W (2.33A@12V DC / 1.17A@24V DC)
Protection	IP6K9K, IP6K8
Weight	600g

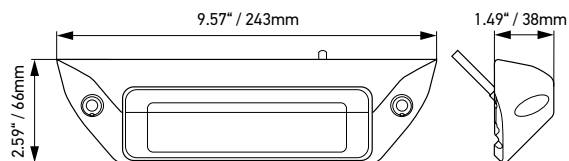

FMS1200 Light Distribution

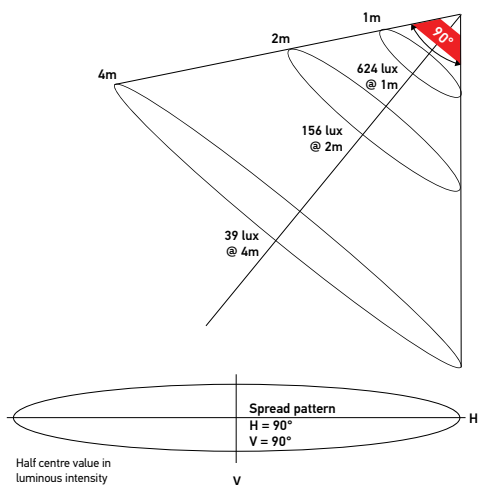

FMS2500 Light Distribution

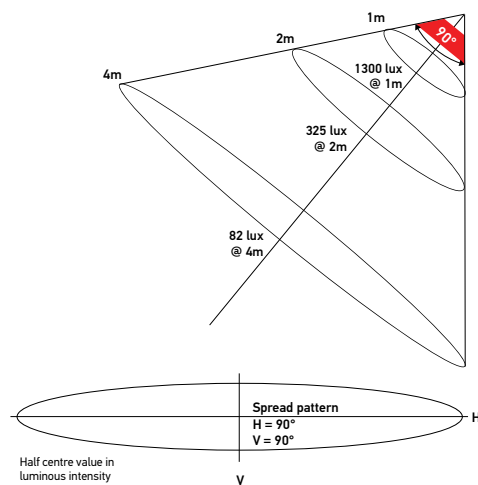

Lamp Type	Black Housing	White Housing
FMS1200	1GB 996 098-001	1GB 996 098-501
FMS2500	1GB 996 098-011	1GB 996 098-511



Module 70 Floodlighting



Compact Module 70 LED flood lights are available in two intensity versions of 800 or 2100 lumen. The housing is finished in a premium CoroSafe coating for proven resistance in extreme operating conditions.



Each Module 70 features a 'close to daylight' 6500K colour temperature. Working under this colour of light reduces the fatigue and eye strain sometimes caused by warmer colour halogen lighting.

Hand held Module 70 search lights are vital tools for night sailing and essential for spotting looming obstacles from a safe distance, or dependable light in an emergency.



Module 70 Gen 3

Housing Material	Die-cast aluminum, CoroSafe coating
Lumen	800 lumen
Colour Temperature	6500K (White)
Cable	Pre-wired with 1m cable
Operating Voltage	Multivolt™ 9 -32V DC
Power Consumption	13W (1.08A@12V DC / 0.54A@24V DC)
Protection	IP6K9K, IP 6K8 (Completely sealed)

Lens Type	Black Housing	White Housing
Close Range	1G0 996 276-452	1G0 996 276-471

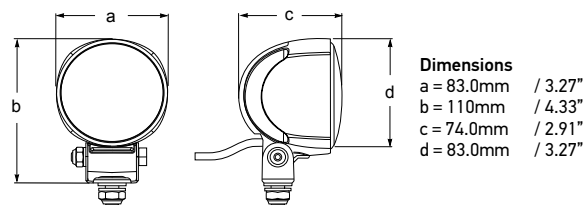

Module 70 Gen 4

Housing Material	Die-cast aluminum, CoroSafe coating
Lumen	2100 lumen
Colour Temperature	6500K (White)
Cable	Pre-wired with 1m cable
Operating Voltage	Multivolt™ 9 -32V DC
Power Consumption	21W (1.75A@12V DC / 0.88A@24V DC)
Protection	IP6K9K, IP 6K8 (Completely sealed)

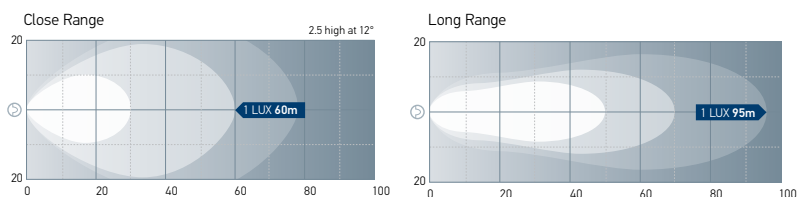
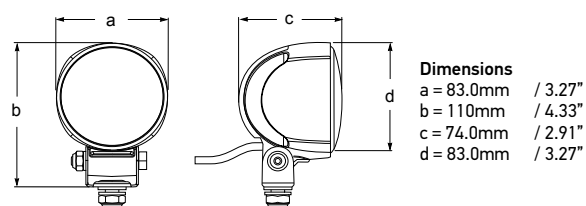

Lens Type	Black Housing	White Housing
Close Range	1G0 996 476-541	1G0 996 476-521
Long Range	1G0 996 476-551	1G0 996 476-531



Hand Held Search Lights

Housing Material	Die-cast aluminum, CoroSafe coating
Lumen	2500 lumen
Cable	Spiral cable with cigarette plug (3.5m)
Operating Voltage	Multivolt™ 9 -32V DC
Power Consumption	30W (2.5@12V DC / 1.25A@24V DC)
Protection	IP6K9K, IP 6K8 (Completely sealed)

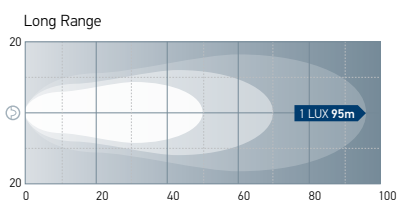
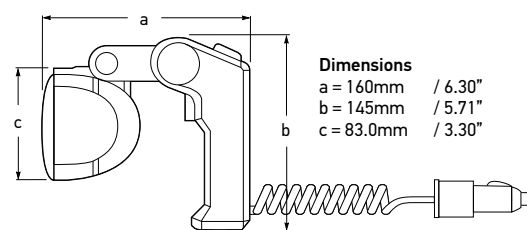

Lens Type	Black Housing
Close Range	1H0 996 476-512
Long Range	1H0 996 476-502

Deck mount
base accessory
8HG 998 519-001



Sea Hawk Light Bars



High output flood lights in a sleek design offer incredible light intensity, efficiency and durability. Thermal polymer corrosion resistant housings provide an ultra long service life.



Sea Hawk 470

The sleek and powerful Sea Hawk 470 range has four light options:

Diffuse flood: extremely wide and even illumination, ideal for areas where a broad amount of light is needed.

Close range: Ideal deck flood light offering bright light to work under for tasks on deck, docking or loading.

Long range: See further with the powerful long range focus, ideal for locating buoys or other objects in the water.

Combination: Three light options of close range, long range or combined in one compact and versatile lamp.

Sea Hawk 350

2200 lumen across all versions without glare:

Spread lamps illuminate a wide, close-range spread over a cockpit, foredeck or working area.

Spot lamps provide a more concentrated illumination for tuna towers, yacht masts or forward facing lighting on a variety of applications.

Pencil Beam lamps have a narrower light angle for locating buoys, moorings and objects over longer distances.

Integrated dual outputs

High output (2200 Lumen / 25W) and low light (220 lumens / 5W) intensity functions in both Spread and Spot lamps.

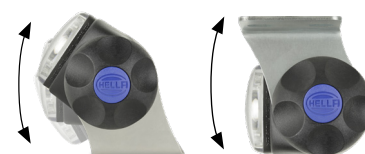

316 Stainless Steel bracket for upright or pendant mount

Sea Hawk 350

Power Consumption	25W (High), 5W (Low)
Lumen	2200 (High)
Voltage	Multivolt™ 12/24V DC
Body Material	Corrosion proof thermal polymer
Lens Material	Heavy Duty Grilamid®

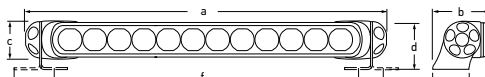

Dimensions

a = 408mm (16.06")
b = 67mm (2.64")
c = 44mm (1.73")
d = 57mm (2.24")
e = 42mm (1.65")
f = 340mm (13.38")
(Mounting Hole)
g = 404mm (15.91")
(Mounting Hole)

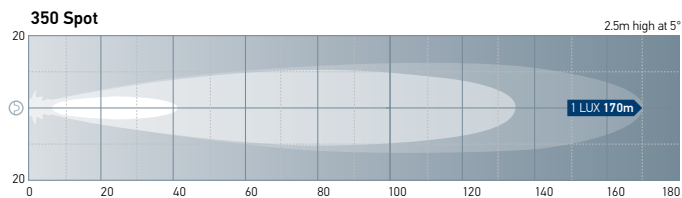

Lens Type	Black Housing	White Housing
Spread	2LT 958 040-701	2LT 958 040-711
Spot	2LT 958 040-651	2LT 958 040-661
Pencil	2LT 958 040-221	2LT 958 040-231



Sea Hawk 470

Power Consumption	36W (High), 4W (Low)
Lumen	3600 (Diffused) 2800 (Spot/Spread)
Voltage	Multivolt™ 12-24V DC
Body Material	Corrosion proof thermal polymer
Lens Material	Heavy Duty Grilamid®

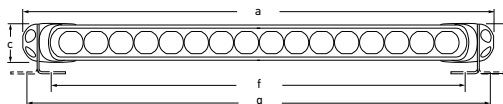

Dimensions:

a = 528mm (20.79")
b = 67mm (2.64")
c = 44mm (1.73")
d = 57mm (2.24")
e = 42mm (1.65")
f = 460mm (18.11")
(Mounting Hole)
g = 524mm (20.63")
(Mounting Hole)

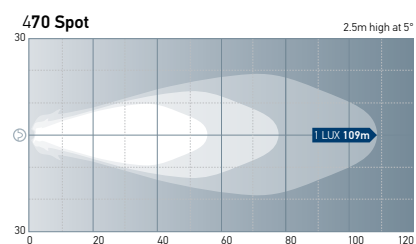
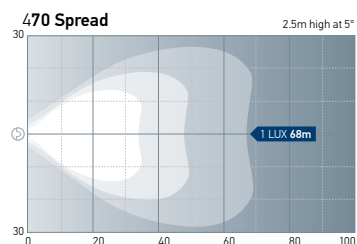

Lens Type	Black Housing	White Housing
Spread	2LT 958 130-601	2LT 958 130-611
Spot	2LT 958 130-631	2LT 958 130-641
Diffused	2LT 958 130-501	2LT 958 130-511
Combi	2LT 958 130-441	2LT 958 130-451

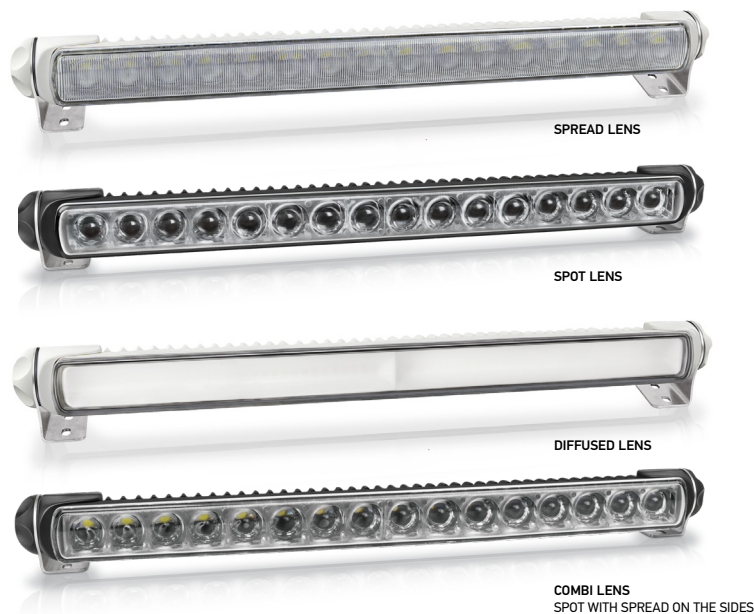

8HG 958 128-811 Accessory
Optional double bracket enables multiple lamps to be stacked to increase the light output or spread of light.



Achieved using one connector



8HG 958 139-881
Light bar connector. The connector allows multiple light bars to be joined in a number of configurations.

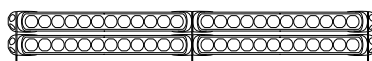

Achieved using two connectors and two Double brackets

Sea Hawk XL Dual Colour Flood Lights



Sports fisherman, commercial operators, and ocean racers recognise the 'non-glare' night vision preservation advantages of red lighting.



Two rows of bright white light is ideal when working, docking or landing the big one while the third row of secondary colour adds versatility. Red is perfect for preserving night vision, blue is a popular and attractive choice when point of difference is needed, while warm white creates added comfort to relax and integrate with interior lighting.

The Sea Hawk XL continues using the high technology materials. A heavy duty Grilamid® lens provides exceptional impact resistance. The unique thermal polymer housing distributes heat away from internal components and avoids potential corrosion issues associated with metal housings.



Sea Hawk XL

Housing Material	Corrosion proof thermal polymer
Lens Material	Heavy duty Grilamid®
Bracket Material	316 Stainless Steel
Lumen	750 lumen
Colour Temperature	5000K (White), 2700K (Warm White)
Cable	Pre-wired with 2.5m marine cable
Operating Voltage	Multivolt™ 9-32V DC
Power Consumption	12W - White LEDs, 6W - Warm White LEDs, 6W - Blue LEDs, 3W - Red LEDs,
Protection	IP67 (Completely sealed)
Weight	750g (including cable)

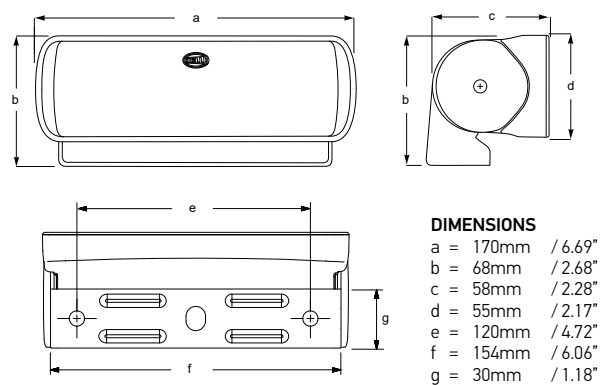

Beam Pattern Dual Colour-Spread

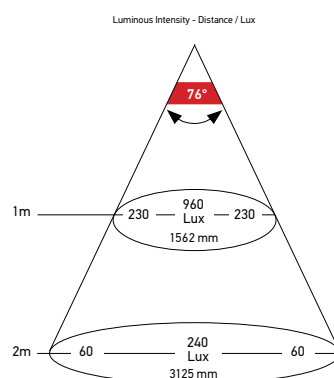
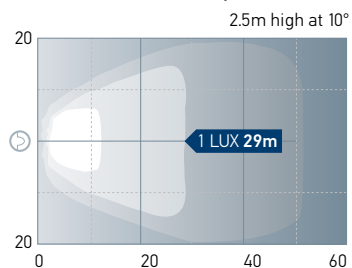

Sea Hawk XL Dual Colour LED Flood Lights - SPREAD

LED Colours	Housing Colour	Part Number
White / Red	Black Housing	2LT 980 950-041
White / Red	White Housing	2LT 980 950-051

LED Colours	Housing Colour	Part Number
White / Blue	Black Housing	2LT 980 950-061
White / Blue	White Housing	2LT 980 950-071

LED Colours	Housing Colour	Part Number
White / Warm White	Black Housing	2LT 980 950-081
White / Warm White	White Housing	2LT 980 950-091

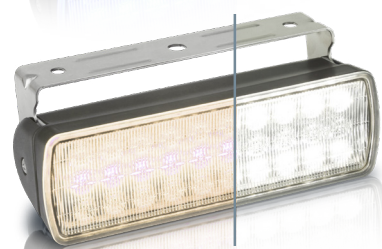
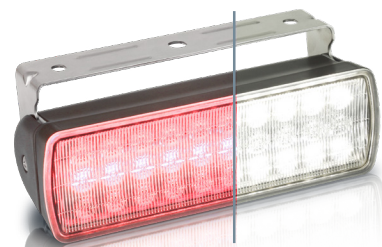

Sea Hawk R & XLR Flood Lights



Energy efficient Hella marine Sea Hawk lamps are completely sealed, lightweight and ultra durable, offering powerful illumination.



Unique Corrosion Proof Housing

The Sea Hawk range provides unmatched corrosion resistance due to an innovative thermally conductive polymer housing removing corrosion risks in the harsh marine environment.

Fully sealed against dust and water ingress
Suitable for the harshest environments.

Engineered light patterns

Advanced optical systems deliver incredible illumination without glare.

Flexible mounting options

The light weight means less stress on mounting locations, and a versatile bracket means aiming the light is a simple affair.

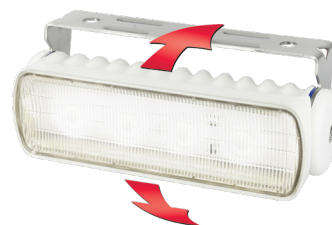

Friction mounts allow adjustment without tools on versions with stainless steel bracket.



Sea Hawk R

Material Description	Corrosion proof thermal polymer
Lens Material	Heavy duty Grilamid®
Bracket (0573 Series)	316 stainless steel
Light Output	550 lumen
Colour Temperature	5000K (White) 3000K (Warm White)
Operating Voltage	Multivolt™ 9-33V DC
Cable	Pre-wired with marine cable
Protection	IP 67 (Completely Sealed)
Power Consumption	7W (0.58A@12V / 0.29A@24V)

Sea Hawk R Bracket Mount

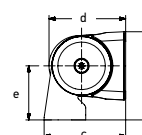
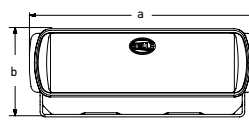

Dimensions
a = 136mm / 5.35"
b = 53.0mm / 2.08"
c = 49.0mm / 1.93"
d = 46.0mm / 1.81"
e = 32.5mm / 1.28"

Sea Hawk R Recessed Mount

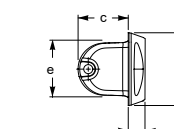
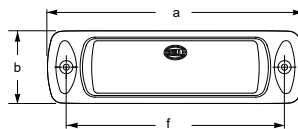

Dimensions
a = 176mm / 6.93"
b = 50.0mm / 1.97"
c = 35.0mm / 1.38"
d = 12.0mm / 0.47"
e = 42.0mm / 1.65"
f = 150mm / 5.91"
g = 132mm / 5.20"

Bracket Mount

Colour	Black Housing	White Housing
White	2LT 980 573-011	2LT 980 573-021
Warm White	2LT 980 573-051	2LT 980 573-061

Recessed Mount

Lens Type	Black Housing	White Housing
Spread	2LT 980 577-001	2LT 980 577-011
Spot	2LT 980 577-201	2LT 980 577-211



Sea Hawk XLR

Housing Material	Corrosion proof thermal polymer
Lens Material	Heavy duty Grilamid®
Bracket Material	316 Stainless Steel
Lumen	1500 lumen
Colour Temperature	5000K (White)
Cable	Pre-wired with 2.5m marine cable
Operating Voltage	Multivolt™ 12 / 24V DC
Protection	IP 67 (Completely Sealed)
Power Consumption	18W (High), 2W (Low)

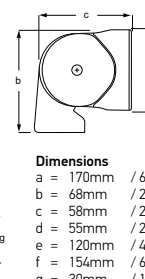
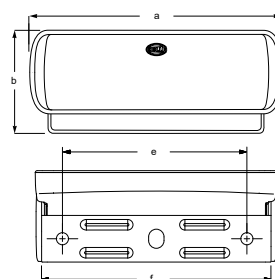

Dimensions
a = 170mm / 6.69"
b = 68mm / 2.68"
c = 58mm / 2.28"
d = 55mm / 2.17"
e = 120mm / 4.72"
f = 154mm / 6.06"
g = 30mm / 1.18"

Lens Type	Black Housing	White Housing
Spread	2LT 980 740-001	2LT 980 740-011
Spot	2LT 980 740-201	2LT 980 740-211



RokLUME Floodlighting



Relentless Hella marine ‘test to destruction’ development programmes have lifted product reliability to new levels. RokLUME lamps endure the worst of vibration, shock and high impact torture tests.



Hella’s optical engineering expertise provides highly effective illumination for working vessels. Option of two light patterns, close range or long range beam patterns offer a crisp white ‘close to daylight’ 5000K colour temperature. Working under this colour of light reduces the fatigue and eye strain sometimes caused by warmer colour halogen lighting.

Electromagnetic Compatibility (EMC) is an increasingly relevant safety concern for many emergency and industrial applications. As electronic devices such as LED lamps become more common, so does the risk of unintended electromagnetic interference (EMI) that can have adverse effects on other sensitive devices such as radios or communication equipment.



316 stainless steel adjustable bracket firmly holds the lamp to withstand harsh vibration and impact.

RokLUME 280

Housing Material	Premium aluminum with NanoSafe coating for non-stick and easy to clean surface.
Bracket Material	Heavy Duty Stainless Steel
Lumen	4400 lumen
Colour Temperature	5000K (Daylight White)
Power Consumption	56W
Operating Voltage	Multivolt™ 12-24V DC
Protection	IP6K8 & IP6K9K - (Protection against dust, prolonged water immersion and high-pressure / steam)
Cable	DT socket (counter plug supplied)
Weight	1.07Kg
Approvals	ECE R10, RCM

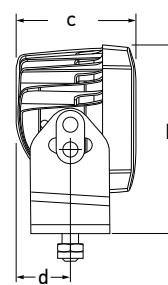
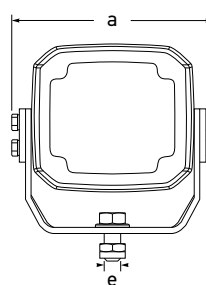

Dimensions:
a = 143mm / 5.61"
b = 133mm / 5.24"
c = 85mm / 3.35"
d = 38mm / 1.5"
e = 10mm / 0.39"

Close Range

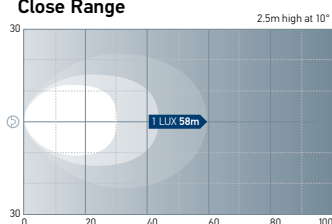

Long Range

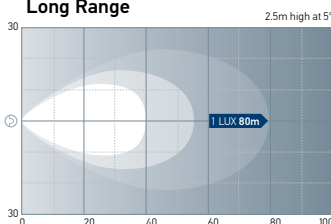

Lens Type	Part Number
Close Range	1GA 995 606-501
Long Range	1GA 995 606-511



Long Range

Close Range

RokLUME 380

Housing Material	Premium aluminum with NanoSafe coating for non-stick and easy to clean surface.
Bracket Material	Heavy Duty Stainless Steel
Lumen	7800 lumen
Colour Temperature	5000K (Daylight White)
Power Consumption	84W
Operating Voltage	20V - 32V DC (Nominal 24V)
Protection	IP6K8 & IP6K9K - (Protection against dust, prolonged water immersion and high-pressure / steam)
Cable	2.0m Double insulated silicone supply cable with bare ends
Weight	2.10Kg
Approvals	ECE R10, RCM

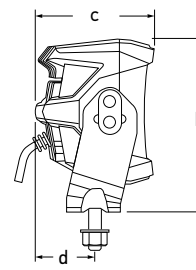
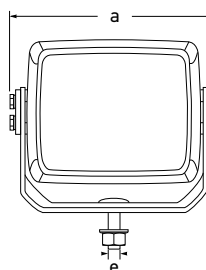

Dimensions:
a = 179mm / 7.05"
b = 148mm / 5.80"
c = 102mm / 4.01"
d = 51mm / 2.0"
e = 10mm / 0.39"

Close Range

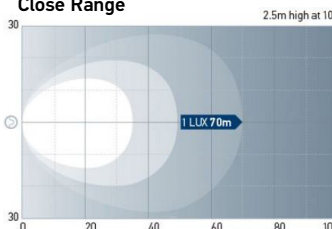

Long Range

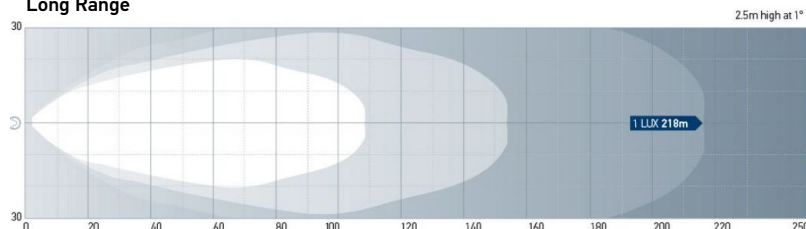

Lens Type	Part Number
Close Range	1GA 996 197-601
Long Range	1GA 995 197-611



Long Range

Close Range

HypaLUME Floodlighting



High performance technology for commercial vessels.
Delivering up to 28,000 lumens, HypaLUME is the most powerful floodlight available from Hella marine.



High Performance

HypaLUME is designed for applications where high output lighting in extreme environments is required. HypaLUME lamps can produce a net output of up to 28,000 lumens whilst consuming less than 300W (AC versions).

Engineered reliability

Comprehensive sealing and anti-corrosion measures have been taken to ensure HypaLUME lamps withstand the toughest conditions. The premium aluminium housing is corrosion resistant with a non-stick and easy to clean surface coating.

Proven durable materials

The heavy duty Grilamid® lens offers unbeatable toughness against impacts and vibration while providing long term UV stability and resistance to commonly used chemicals for the entire life of the product.

Benchmark working light colour

White 'close to daylight' 5700K colour temperature. Working under this colour of light reduces the fatigue and eye strain often caused by warmer colour halogen lighting.

Secure installation

The ultra heavy duty 316 stainless steel bracket firmly grips the HypaLUME to withstand harsh vibration and impact while also providing easy vertical angle adjustment of up to 140°.

Reliable in extreme conditions

HypaLUME is purpose designed to operate over an extreme temperature range from -40°C to +50°C. Advanced thermal management works to support the class leading 5 year warranty.

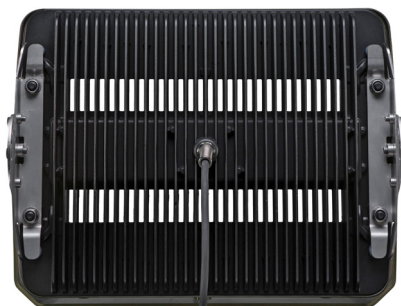

Heavy duty 316 stainless steel bracket allows vertical angle adjustment.

HypaLUME

Operating Voltage	100 to 240V AC	22 to 50V DC
Power Consumption	300W max.	260W max.
Lumen	28000 lumen	25000 lumen
Protection	IP66 and IP67 (Protection against dust and high pressure water jets and temporary water immersion) Over-temperature protection	IP6K9K (Fully sealed against dust and high-pressure / steam jet cleaning) Advanced thermal management. Reverse polarity, transient spike and over voltage protection
Cable Length	Supplied with 2.0m of easy plug-in sheathed cable	Supplied with 1.8m of easy plug-in sheathed cable
Connection	Wieland RST Mini - 16A	4 Pin Deutsch plug
Approvals	CE, RCM, FCC, ISO 13766, CISPR25	

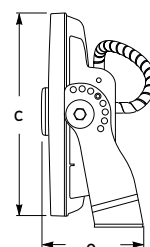
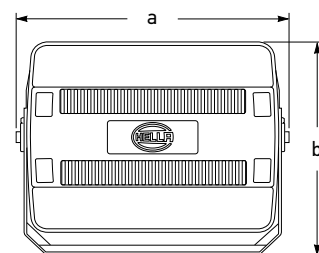

AC

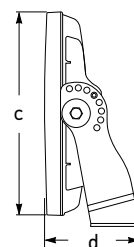

DC

Dimensions

110 / 230V AC

a = 520mm / 20.47"

b = 380mm / 15.9"

c = 359mm / 14.13"

e = 180mm / 07.08"

24 / 48V DC

a = 520mm / 20.47"

b = 380mm / 15.9"

c = 359mm / 14.13"

d = 166mm / 06.54"

Beam Pattern **Extra Wide** 1GJ 958 334-031

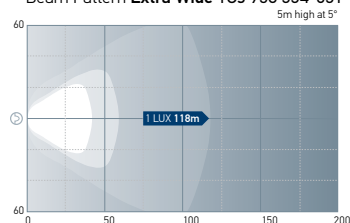

Beam Pattern **Close Range** 1GJ 958 334-011

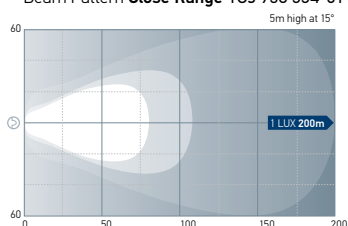

Beam Pattern **Long Range** 1GJ 958 334-021

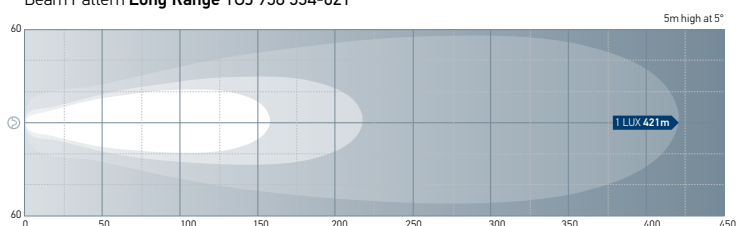

HypaLUME 110 / 230V AC LED Flood Lights

Lens Type	Part Number
Close Range	1GJ 958 334-011
Long Range	1GJ 958 334-021
Extra Wide	1GJ 958 334-031



Side view



Rear view

HypaLUME 24 / 48V DC LED Flood Lights

Lens Type	Part Number
Close Range	1GJ 011 872-501
Long Range	1GJ 011 872-511
Extra Wide	1GJ 011 872-521



Side view

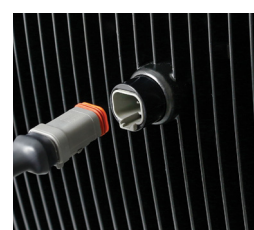

DT connection

NaviLED Navigation Lamps



Designed and manufactured in New Zealand and proven on the harshest waters worldwide, Hella marine LED navigation lamps provide power saving, highly visible and ultra durable lighting for reliability and safety at sea.



Ultra Low Power Consumption

Combining efficient LED light sources with advanced optic technology, Hella marine LED products deliver more light output per watt and provide considerable power saving.

No bulbs, No maintenance. Ultra long service life

Hella marine LED technology has no filaments to break, thus making the LED lamps extremely shock and vibration resistant for reliable illumination and safety. Our engineering teams have developed a unique range of highly demanding tests to lift product reliability to new standards.

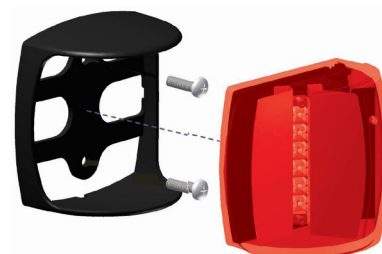

Sealed light engine clips into mounting shroud for an ultra secure attachment.



Safe and highly visible

Advanced LED navigation lamp optics deliver optimal horizontal and vertical light distribution according to international standards. They provide enhanced visibility compared to bulb navigation lamps. Cut-off angles are ultra precise, clearly indicating a vessel's movement and heading.

Fully sealed for life

Each Hella marine LED lamp is a completely sealed opto-electronic device. Proven design, precision engineering, and the use of high impact acrylic materials ensures superior resistance to water, impact, UV and general wear and tear.



Superior Lens and Optic Materials for long life

All Hella marine LED navigation lamps feature extra thick lenses. Taking ultra durable lighting to a new level, Hella marine specifies Grilamid®, a high performance polyamide manufactured in Switzerland, as a standard or optional lens choice. Grilamid® is a revolutionary transparent plastic with an exceptionally high impact strength and resistance to UV and chemical damage.

Pre-wired with marine cable

Hella marine LED lamps are pre-wired with quality marine specification tinned cable. The cable is completely sealed to the lamp body providing time saving at installation and reliable electrical connection.

Multivolt™ technology for durability and safety

Advanced Multivolt™ circuitry provides a uniform level of intensity for reliable and safe illumination across a range of DC inputs such as 9-33 volts.

Multivolt™ LED lamps can be connected to 12 or 24 volt systems without modification, providing full light performance and automatic compensation for low battery voltages and voltage drop over long cables and connections. Multivolt™ LED lamps are also reverse polarity and spike protected for enhanced durability even under severe voltage fluctuations.

Electromagnetic Compatibility (EMC)

All Hella marine products are designed to suppress electromagnetic interference, complying with the emission and immunity limits prescribed in international standards. This protects the radio, communication, navigation and other electrical equipment onboard from possible interference with our products. Where applicable, Hella marine products carry CE marking for European Union legislation, and the C-Tick mark for Australian & New Zealand requirements.

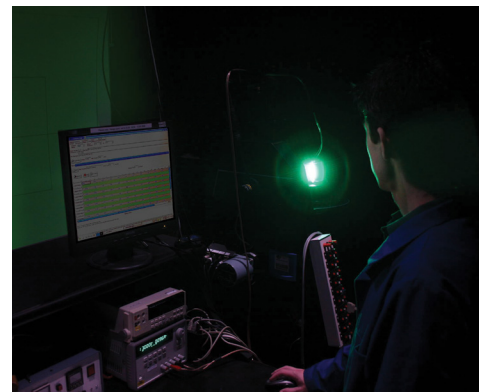

Photometric Testing

NaviLED PRO lamps have ultra precise horizontal and vertical cut-off angles to clearly indicate a vessel's movement and heading.

Every individual NaviLED PRO is photometrically verified in production by a sophisticated goniometer to ensure compliance with the intensity and cut-off requirements of international navigation lamp standards.

After passing photometric testing, a unique serial number is laser engraved onto the lens. This serial number is referenced to individual test reports which are electronically archived by Hella marine, ensuring international navigation lamp standards are consistently met.

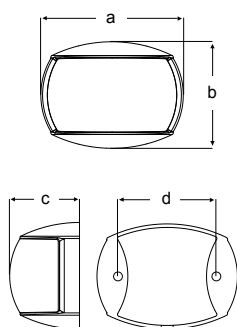

Dimensions
a = 71mm / 2.80"
b = 53mm / 2.09"
c = 33mm / 1.30"
d = 50 mm / 1.97"

BSH Approved for Powerboats and Yachts

Material Description	UV resistant, enhanced impact resistant acrylic lens. High impact shroud
Minimum Visible Distance	2 Nautical Mile (Yachts and Powerboats)
Cable	Pre-wired with marine cable
Operating Voltage	Port, Starboard and Stern Lamps Multivolt™ 9-33V DC
Voltage Protection	Spike protected to +500 volts Reverse polarity protected to -700 volts
Power Consumption	Port and Starboard less than 2W combined. Stern less than 2W,
Protection	IP 67 (Completely Sealed)
Weight	60g (including 120mm single core cable)
Approvals	IMO COLREG, USCG, RINA, ABYC A-16, BSH, RCD

Single Lamps (120mm of single core marine cable)

Lamp Type	Visibility	Black Shroud	White Shroud
Port	2 NM	2LT 980 520-061	2LT 980 520-071
Starboard	2 NM	2LT 980 520-261	2LT 980 520-271
Stern*	2 NM	2LT 980 520-501	2LT 980 520-511

Single Lamps (2.5m of twin core marine cable)

Lamp Type	Visibility	Black Shroud	White Shroud
Port	2 NM	2LT 980 520-081	2LT 980 520-091
Starboard	2 NM	2LT 980 520-281	2LT 980 520-291
Stern*	2 NM	2LT 980 520-531	2LT 980 520-541

*Stern lamps have a clear lens

Port & Starboard Pairs (with 120mm of single core marine cable)

Lamp Type	Visibility	Black Shroud	White Shroud
Port & Starboard	2 NM	2LT 980 520-861	2LT 980 520-871

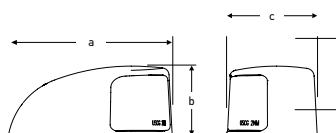

Dimensions:
a = 90.0mm / 3.54"
b = 38.5mm / 1.52"
c = 50.0mm / 1.97"

2 Nautical Mile Powerboat & Yacht Lamps

Lamp with Coloured Lens	Black Housing	White Housing
Port & Starboard (2NM)	2LT 980 620-801	2LT 980 620-811
Lamp with Clear Lens	Black Housing	White Housing
Port & Starboard (2NM)	2LT 980 620-901	2LT 980 620-911



BSH Approved for Powerboats and Yachts

Material Description	High impact resistant acrylic lens or Ultra heavy duty Grilamid® lens.
Cable	Pre-wired with 2.5m of twin core marine cable
Operating Voltage	Multivolt™ 9-33V DC
Voltage Protection	Spike protected to +500 volts Reverse polarity protected to -700 volts
Power Consumption	Port, Starboard and Stern - Less than 3.2W combined. Masthead - Less than 2.5W
Protection	IP 67 (Completely Sealed)
Weight	150g (including cable)
Approvals	Wheelmark, IMO COLREG, USCG, ABYC A-16 RINA, BSH, RCD.

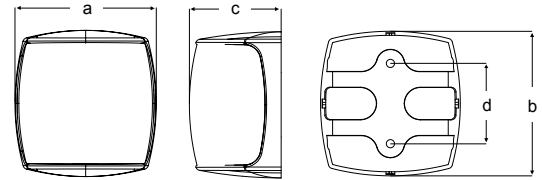

Dimensions
a = 87mm / 3.43"
b = 90mm / 3.54"
c = 57mm / 2.25"
d = 50mm / 1.97"

BSH Approved for Powerboats and Yachts - Acrylic Lens

High Impact Lens for Powerboats and Yachts			
Lamp Type	Visibility	Black Shroud	White Shroud
Port	2 NM	2LT 959 900-501	2LT 959 900-511
Starboard	2 NM	2LT 959 908-501	2LT 959 908-511
Stern	2 NM	2LT 959 909-501	2LT 959 909-511



BSH Approved for Powerboats and Yachts - HD Grilamid® Lens

Ultra Heavy Duty Lens for Powerboats and Yachts			
Lamp Type	Visibility	Black Shroud	White Shroud
Port	2 NM	2LT 959 900-601	2LT 959 900-611
Starboard	2 NM	2LT 959 908-601	2LT 959 908-611
Stern	2 NM	2LT 959 909-601	2LT 959 909-611
Bi-Colour	2 NM	2LT 959 941-001	2LT 959 941-011
Masthead*	3 NM	2LT 959 940-601	2LT 959 940-611
Masthead*	5 NM	2LT 959 940-401	2LT 959 940-411

* for Powerboats and Sailing Yachts under motor



NavILED PRO Deck Mount Adaptor

Black Housing	White Housing
8HG 241 287-802	8HG 241 287-812

The NavILED PRO Deck Mount Adaptor allows the NavILED PRO lamps to be mounted on a horizontal surface.

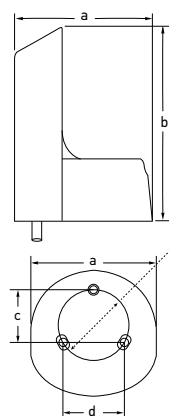

Dimensions
a = 90mm / 3.54"
b = 128mm / 5"
c = 38mm / 1.5"
d = 44mm / 1.73"
e = 50.8mm / 2"



COLREG and Wheelmark Certified All Round Lamps

Housing Material	Corrosion, UV and impact resistant plastic
Lens Material	Heavy duty Grilamid®
Minimum Visible Distance	2 Nautical Mile
Cable	Pre-wired with marine cable
Operating Voltage	Multivolt™ 12 / 24V DC
Power Consumption	1W
Protection	IP 67 (Completely sealed)
Approvals	IMO Col Reg 72, USCG, Wheelmark, ABYC A-16, RCD

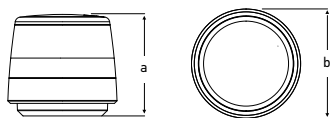

Dimensions

a = 56mm / 2.20"
b = 60mm / 2.36"

Anchor Lamps with Compact Surface Mount Base

Height	Visibility	Black Base	White Base
56mm (2.2")	2 NM	2LT 980 960-001	2LT 980 960-011

Anchor and all round lamps with Wide Base

Light Colour	Visibility	Black Base	White Base
White	2 NM	2LT 980 910-121	2LT 980 910-131
Red	2 NM	2LT 980 910-521	2LT 980 910-531
Green	2 NM	2LT 980 910-321	2LT 980 910-331

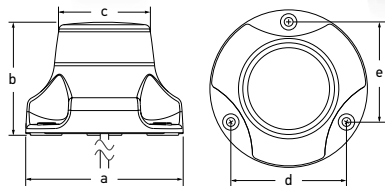
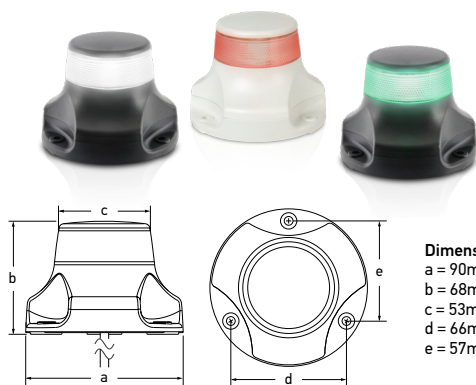

Dimensions

a = 90mm / 3.54"
b = 68mm / 2.68"
c = 53mm / 2.09"
d = 66mm / 2.60" (mounting holes)
e = 57mm / 2.24" (mounting holes)

Fixed Pole Anchor Lamps

Overall Length	Visibility	Black Base	White Base
167mm (6")	2 NM	2LT 980 960-201	2LT 980 960-211



Fold Down Anchor Lamps

Overall Length	Visibility	Black Base	White Base
204mm (8")	2 NM	2LT 980 960-281	2LT 980 960-291
315mm (12")	2 NM	2LT 980 960-301	2LT 980 960-311
510mm (20")	2 NM	2LT 980 960-321	2LT 980 960-331
605mm (24")	2 NM	2LT 980 960-341	2LT 980 960-351
865mm (34")	2 NM	2LT 980 960-361	2LT 980 960-371
1016mm (40")	2 NM	2LT 980 960-461	2LT 980 960-471

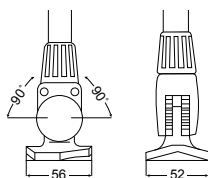

Plug-in Pole Anchor Lamps

Overall Length	Visibility	Black Base	White Base
610mm (24")	2 NM	2LT 980 960-401	2LT 980 960-411
1080mm (42")	2 NM	2LT 980 960-421	2LT 980 960-431
1380mm (54")	2 NM	2LT 980 960-441	2LT 980 960-451

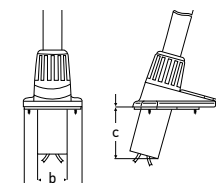
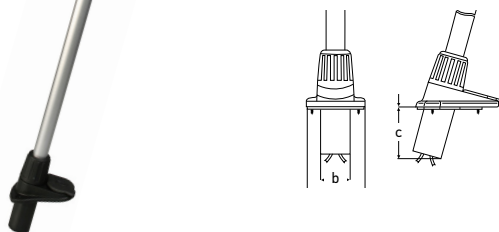

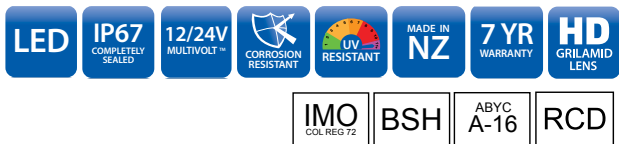

COLREG and BSH Certified LED Tri Colour with Anchor

Housing Material	UV resistant, high impact nylon
Lens Material	UV resistant, heavy duty Grilamid®
Mounting Shaft	316 stainless steel
Minimum Visible Distance	2 Nautical Mile (Yacht)
Cable	Pre-wired with 400mm of triple core marine cable
Operating Voltage	Multivolt™ 9-33V DC
Voltage Protection	Spike protected to +500 volts Reverse polarity protected to -700 volts
Power Consumption	Port, Starboard and Stern - Less than 3.5W combined All Round White / Anchor - Less than 1.5W
Protection	IP 67 (Completely Sealed)
Weight	400g (including cable)
Approvals	BSH, IMO COLREG, USCG, ABYC, RCD
Warranty	Seven Years



Innovative mounting system for easy and secure installation

316 Stainless steel mounting shaft and base

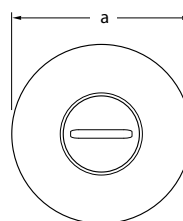

Top Profile

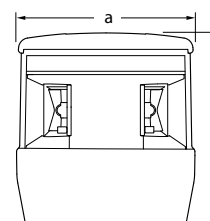

Side Profile

Dimensions

a = 85mm / 3.35"
b = 95mm / 3.74"

Tri Colour Lamp with Anchor

Visibility	Black Base
2 NM	2LT 980 650-001



NavILED Trio Windex Adaptor Nut

Part Number

9NM 958 988-402

Machined 316 stainless steel adaptor nut to install a Windex directly onto the LED Tri Colour mounting shaft. M12 (Mounting Shaft) to 5/16UNC. Female to female.



Submersible LED Trailer Lamps



The full combination of functions are offered including LED stop, rear position and rear indicator lamps, number plate illumination plus an integrated 18cm² red reflector. Each lamp is completely sealed against dust and moisture ingress.

0720 Series LED Combination Lamps



Lens Material	Heavy duty Grilamid® lens
Mounting	Horizontal or vertical
Operating Voltage	Multivolt™ 12/24V DC
Power Consumption	Rear position 1W, Indicator 2W, Stop 2W
Voltage Protection	Spike, Over Voltage and Reverse Polarity
Cable	0.5m Pre-wired with multi-core cable
Approvals	ADR compliant, ECE certified

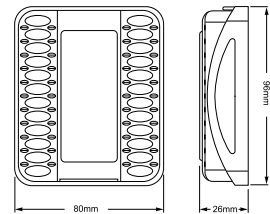

Trailer Lamp Function	Side	Part Number
LED Stop/Rear Position/Rear Direction Indicator Lamp with Number Plate Function	Right	2VB 980 720-401
LED Stop/Rear Position/Rear Direction Indicator Lamp with Number Plate Function	Left	2VB 980 720-501
LED Stop/Rear Position/Rear Direction Indicator Lamp w/o Number Plate Function		2VA 980 720-001

9010 & 9011 Series LED Lamps



Lens Material	High impact acrylic
Mounting	Single Bolt, optional Red Reflex Reflector Base
Operating Voltage	12-24V DC
Power Consumption	Rear position 1W, Indicator 3W, Stop 3W Fog 3W, Reverse 4W
Voltage Protection	Spike, Over Voltage and Reverse Polarity
Cable	Pre-wired with 2.5m of cable
Approvals	ADR compliant, ECE certified

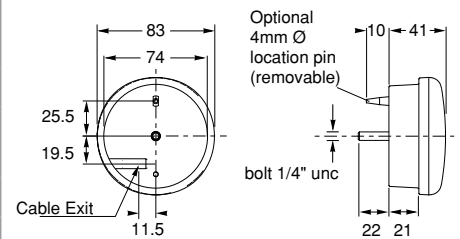

Submersible Rear Combination Lamp	
Description	Part Number
Single Rear Position / Stop / Indicator Lamp	2SD 959 010-201

Submersible Single Function Lamps			
Description	Part Number	Description	Part Number
Fog	2NE 959 011-501	Reverse	2ZR 959 010-501



Submersible LED Position Lamps



Surface Mount LED Marker Lamps

Operating Voltage	Multivolt™ 8-28V DC
Power Consumption	<1W
Approvals	ADR compliant, ECE certified

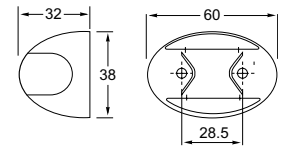

DuraLED Front Position / End Outline Lamps		
Quantity	Cable Length	Part Number
2 pcs	500mm	2PF 959 570-202
2 pcs	5m	2PF 959 570-212



DuraLED Rear Position / End Outline Lamps		
Quantity	Cable Length	Part Number
2 pcs	500mm	2XA 959 560-401
2 pcs	5m	2XA 959 560-411



Flush Mount LED Marker Lamps

Operating Voltage	Multivolt™ 9-33V DC
Power Consumption	<1W
Approvals	ADR compliant, ECE certified

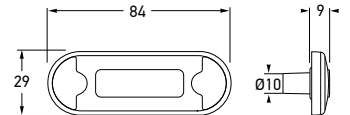

Front Position / End Outline. Horizontal or vertical mounting		
Quantity	Cable Length	Part Number
1	500mm	2PF 959 855-201
1	2.5m	2PF 959 855-241



Rear Position / End Outline. Horizontal or vertical mounting		
Quantity	Cable Length	Part Number
1	500mm	2XS 959 855-401
1	2.5m	2XS 959 855-441

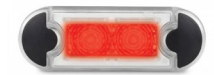

Side Marker. Horizontal mounting only		
Quantity	Cable Length	Part Number
1	500mm	2PS 980 868-201
1	2.5m	2PS 980 868-211



LED Number Plate Lamp

Operating Voltage	Multivolt™ 10-33V DC
Approvals	ADR compliant, ECE certified

Note - Two units required for Europe.

Part Number
2KA 959 640-601

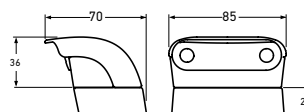

ECE Triangle Reflector

Part Number
8RA 002 020-051

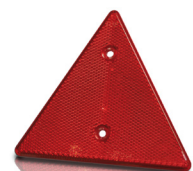
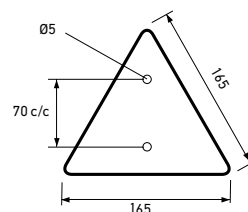

Water Resistant Plugs and Sockets

Chrome brass plugs and sockets for exterior or interior installations.
Socket includes plastic cap. Plug suitable for cable up to 6.5mm diameter.



Material Description	Chrome brass housings. Brass contacts
Maximum Load	22A at 12V
Installation	Screw terminals

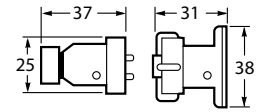

Description	Part Number
2 Pin	8JA 002 620-801
3 Pin	8JA 002 807-801
4 Pin	8JA 002 957-801

Chrome Brass Deck Glands - Ensures waterproof cable entry



Cable Diameter	Gland dimensions	Part Number
Cables up to 8mm dia.	18mm high x 32mm base	9NM 004 208-001
Cables up to 12mm dia.	18mm high x 38mm base	9NM 004 209-001

Watertight plastic plugs and sockets for exterior or interior installations.
Socket includes plastic cap. Plug suitable for cable up to 8.0mm diameter.

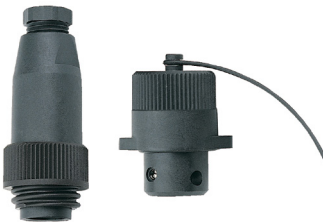

Material Description	Impact resistant plastic housing Silver contacts
Protection	IP 67
Maximum Load	2 to 4 pin: 16A at 12V. 7 pin: 10A at 12V
Installation	2 to 4 pin: Screw terminals 7 pin: Solder terminals
Mounting	2 to 4 pin: Flush mounting 7 pin: Surface mounting

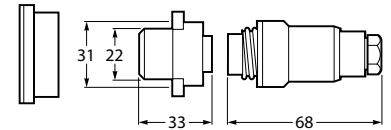

Description	Part Number
2 Pin Plug and Socket	8JA 006 801-801
3 Pin Plug and Socket	8JA 006 803-801
4 Pin Plug and Socket	8JA 006 805-801
7 Pin Plug and Socket	8JA 006 807-801



Socket Surface Mounting Ring
Includes screws and gasket

Part Number

8XT 006 **798**-001

Two Speed Hella marine Turbo Fans

Internationally respected Hella Turbo fans may be turned and pivoted in all directions and locked into position.

- Quality German motor for quiet operation
- 150mm diameter fan blade with guard
- High air moving capacity with low power consumption
- Two speed switch in front of the blade guard
- Side, upright or pendant mounting

Material Description	Impact resistant plastic
Switch	Integrated 2 stage rotary
Output	Speed 1: 70 litre / sec. Speed 2: 95 litre / sec.
Power Consumption	6.5W
Installation	Pre-wired with 1.4m / 4.6ft of cable

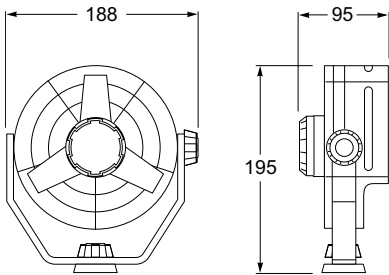

Voltage	Housing Colour	Part Number
12V	Black Housing	8EV 003 361-002
12V	White Housing	8EV 003 361-022
24V	Black Housing	8EV 003 361-012

Push Button Switches



Attractive, exterior durable, stainless steel switches featuring an appealing ring of LED light.

Manufactured from 304 stainless steel, these through panel mount switches are IP 67 rated when installed and ideal for switching lighting or installing into custom switch panels. The light rings may be wired to show power to a system or signal circuit activation. The range also includes matching stainless steel warning buzzers with LED light rings.

Body Material	304 Stainless Steel
Contact Material	Silver Alloy
Terminal Type	5 Pin (2.8 x 0.5mm) switches 2 screws for buzzer
Panel Thickness	1~ 10mm
Operating Temp	-20°C~ +55°C
Insulation Resistance	≥ 1000mΩ
Contact Resistance	≤ 50mΩ
Max. Switch Rating	5A
Protection	IP 67 for switches IP 50 for buzzer
Buzzer sound intensity	>80dB (1m)

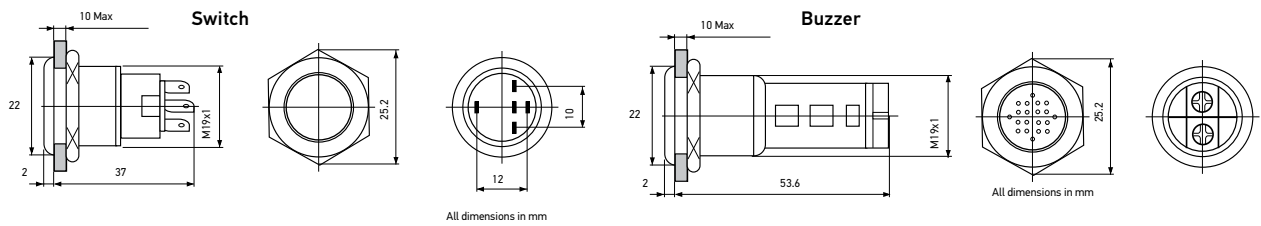
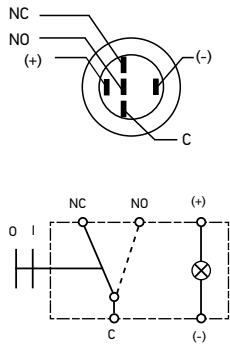

Latching Switches with LED Ring			
Light Colour	Voltage	Operation	Part Number
Red	12V DC	On / Off	8HG 958 455-001
Blue	12V DC	On / Off	8HG 958 455-011
Red	24V DC	On / Off	8HG 958 455-101
Blue	24V DC	On / Off	8HG 958 455-111

Momentary Switches with LED Ring			
Light Colour	Voltage	Operation	Part Number
Red	12V DC	Momentary	8HG 958 455-201
Blue	12V DC	Momentary	8HG 958 455-211
Red	24V DC	Momentary	8HG 958 455-301
Blue	24V DC	Momentary	8HG 958 455-311

Marine Switch Pigtail Loom	
	Part Number
Switch Harness to suit 958 455-xxx switch series	8KB 990 258-021



Buzzers with LED Ring			
Light Colour	Voltage	Operation	Part Number
Red	12V DC	Buzzer	8HG 958 456-001
Red	24V DC	Buzzer	8HG 958 456-101

2 Group Light Dimmer

- Precise dimming control for 1 or 2 light groups
- Voltage regulation & 'soft-start' bulb protection
- Low voltage battery protection
- 12V and 24V DC

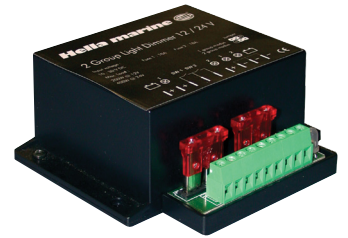

The 2 Group Light Dimmer provides precise dimming control for one or two separate light groups, and sophisticated voltage regulation with a 'soft-start' feature to lengthen the life of incandescent bulbs. The dimmer also provides low voltage protection against deep battery discharge.

The dimmers low voltage protection also protects against deep battery discharge. Lights will turn off automatically when battery voltage is lower than 9V on a 12V system or lower than 18V on a 24V system. Lights can be switched on again when the battery is charged and reaches 12V or 24V respectively.

Max. Load	200W at 12V and 400W at 24V
Max. Load Per Group	100W at 12V and 200W at 24V
Input Voltage Range	8 - 30V DC
System Voltage	12V or 24V DC
Number of Groups	2
Switches Per Group	Unlimited
Switch Type	Momentary normally open
Weight	140 grams
Protection	Overload, Temperature, Low voltage
Fuse	2 x 10A
PWM Frequency	400Hz

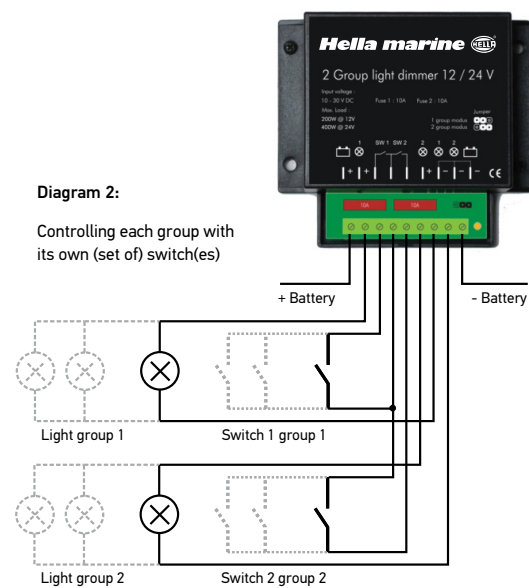
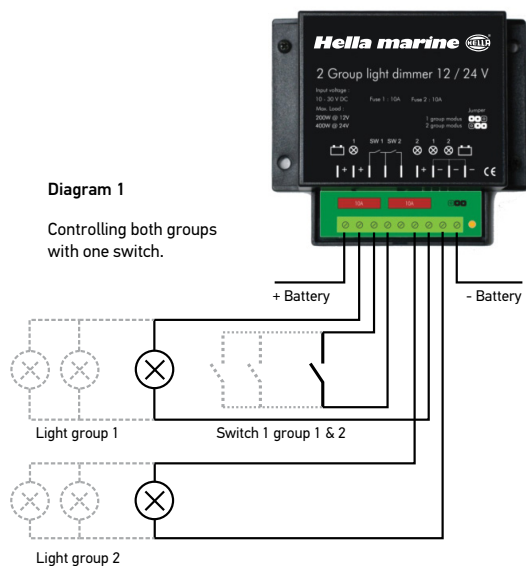
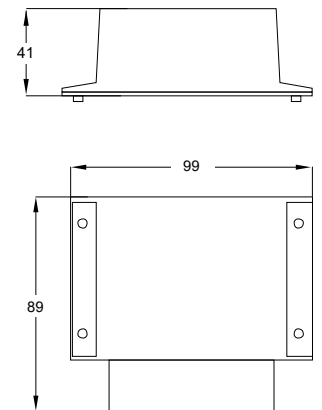

Part Number

5XA 998 572-001

Battery Master Switches

275 Amp Battery Master Switch

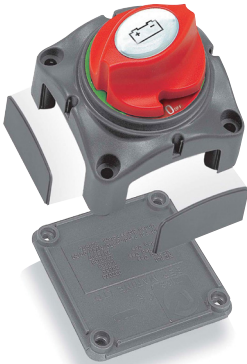

Contour Lock system with removable plates allows the switch to be a stand alone unit or locked together with other switches. The control knob can not be removed whilst in an ON or OFF position, however it can be removed by switching to an anti-clockwise 45° position.

Suitable for surface or recess mounting by cutting a 52mm diameter hole.

Material Description	Impact resistant plastic. Copper studs.	
Termination Stud Size	2 x 10mm (3/4")	
Operation	ON / OFF	
Protection	IP 56	
Max. Load 12 / 24V DC	Continuous	275 Amps
	Intermittent	455 Amps (5 minutes)
	Cranking	1250 Amps (10 seconds)
Max. Voltage	48V DC	

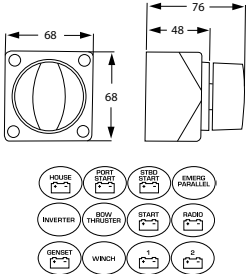

Part Number
6EK 998 540-001 Spare label set 9XT 998 011-001

600 Amp Battery Master Switch



Contour Lock system with removable plates allows the switch to be a stand alone unit or locked together with other switches. The control knob can not be removed whilst in an ON or OFF position, however it can be removed by switching to an anti-clockwise 45° position.

Suitable for surface or recess mounting by cutting a 85mm diameter hole.

Material Description	Impact resistant plastic. Copper studs.	
Termination Stud Size	2 x 12mm (1/2")	
Operation	ON / OFF	
Protection	IP 56	
Max. Load 12 / 24V DC	Continuous	600 Amps
	Intermittent	800 Amps (5 minutes)
	Cranking	2500 Amps (10 seconds)
Max. Voltage	48V DC	

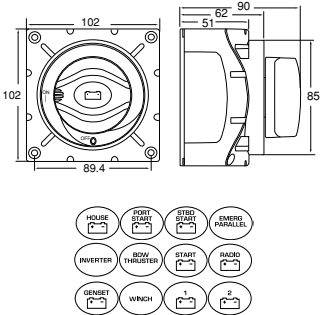

Part Number
6EK 998 540-061 Spare label set 9XT 998 011-001

350 Amp Battery Selector Switch



Contour Lock system with removable plates for connection from all sides.

This allows the switch to be a stand alone unit or locked together with battery distribution modules. Necessary for on board systems fed from 2 or more batteries and whose supply comes from more than 1 generator. Rotary switch in 4 switch positions of battery 1-2-Both-OFF. Switch can also be pad locked. Suitable for surface or recess mounting by cutting an 85mm diameter hole.

Material Description	Impact resistant plastic. Copper studs.	
Termination Stud Size	3 x 10mm (3/4")	
Operation	1-2-Both-OFF	
Protection	IP 56	
Max. Load 12 / 24V DC	Continuous	350 Amps - B1 or B2
	Continuous	500 Amps - B1 and B2
	Intermittent	500 Amps (5 minutes)
	Cranking	1500 Amps (10 seconds)
Max. Voltage	48V DC	

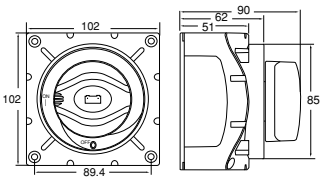

Part Number
6EB 998 540-201

Battery Master Switches

2843 Series - 150 Amp Battery Master Switch

Positive or negative cable can be switched as required.
Key can be removed in the OFF position, current interrupted.

Housing Description	Impact resistant plastic
Cable Connection	2 screw terminals, M10
Protection	IP X4
Max. Load	12V / max. 1000A (10 seconds) 24V / max. 500A (10 seconds) (compliant with VDA 72750)
Part Number	Spare Key Number
6EK 002 843-051	9SL 706 729-011

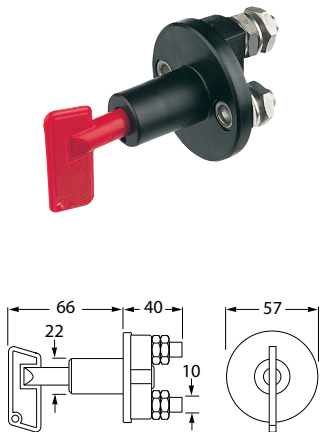

1559 Series - 100 Amp Battery Master Switch

Heavy duty switch for high loads.
Key can be removed in the OFF position, current interrupted. Positive or negative cable can be switched as required.

Housing Description	Steel key and mounting plate
Cable Connection	2 screw terminals, M10
Protection	IP X4
Max. Load	12V / 24V max. 2500A (10 seconds)
Max. Continuous Load	12V / 24V max. 100A 24V / max. 2500A (10 seconds) (compliant with VDA 72750)
Part Number	Spare Key Number
6EK 001 559-001	9SL 042 991-001

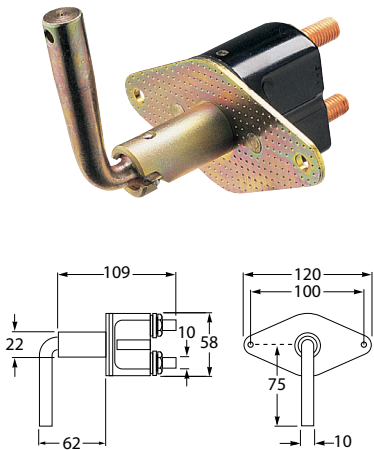

Voltage Sensitive Relay



“Dual battery charging made easy”, the Voltage Sensitive Relay (VSR) allows two batteries to be charged at the same time.
When the engine is started and the start battery reaches 13.7 volts, the VSR engages, allowing two battery banks (start and auxiliary) to be charged simultaneously.
When the voltage drops below 12.8 volts (eg the engine is stopped), the VSR disengages, separating the batteries. This system eliminates the possibility of draining the start battery and protects sensitive electronic equipment powered from the auxiliary battery from harmful engine start up spikes.

Housing Description	Impact resistant plastic. Copper studs.
Termination Stud Size	2 x 6mm (1/4")
Protection	IP 56
Voltage	12V DC
Max. Load 12 DC	140 Amps
Dimensions	68 x 68 x 50mm (W x D x H)
Part Number	
5RD 998 556-011	

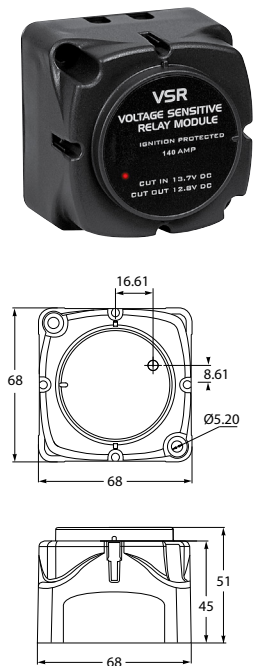



Hella marine

Warranty - Standing behind the product

All LED based lighting products supplied by Hella marine carry a Five-Year Warranty from end user purchase covering faults in materials, components or workmanship, with the exceptions as stated below:

- Hella marine NaviLED TRIO Tri Colour LED navigation lamps carry a Seven-Year Warranty

In the unlikely event that you should experience a confirmed warranty related problem with your purchase, Hella marine will, at its discretion, either repair, replace or refund the purchase price of the product.

Warranty services may be obtained by returning the product within the warranty period to the Hella dealer where the product was originally purchased.

This warranty is in addition to and does not preclude any other rights or remedies available to the consumer under any local legislation related to the provision of goods or services.

This warranty does not cover:

1. Claim(s) as a result of normal wear and tear or of any modifications and/or alterations to the product in any shape or form.
2. Claim/s as a result of non-compliance of the assembly, service and operating instructions and/or any unfit or improper use.
3. Any expenses incurred in the process of making the claim.



Navigation Lamp Approvals

Hella marine navigation lamps comply with the International Regulations for Prevention of Collisions at Sea (IMO COLREG 72).

This IMO compliance, together with supplementary national or regional requirements, is listed with each navigation lamp series throughout the catalogue.

Approval types:



Complies with IMO (International Maritime Organization) requirements under the International Regulations for the Prevention of Collisions at Sea. (IMO COLREG 72). IMO COLREG 72 forms the international basis for legal navigation lighting on vessels.



Approved under the Marine Equipment Directive (MED) 96/98/EC last modified by directive 2008/67/EC for use throughout Europe in all EC member states for both pleasure and commercial vessels.



Suitable for vessels compliant with RCD (Recreational Crafts and Personal Watercraft Directive) 2013/53/EU. RCD promotes a single set of EU safety and technical requirements for new recreational vessels less than 24m in length within the European Community.



Complies with USCG (United States Coast Guard) requirements. Lamps carry a marking for minimum visible distance in nautical miles, e.g. USCG 2 NM.



Complies with ABYC (American Boat and Yacht Council) Navigation Lamp Standard A-16.



Approved for placement on UK ships. Carries the UK conformity mark for marine equipment, the 'Red Ensign'. Required from 1st January 2023.

Certifying bodies:



Approved by the German BSH (Bundesamt für Seeschifffahrt und Hydrographie) and carry BSH type approval numbers.
BSH was formerly called DHI (Deutsches Hydrographisches Institut).



Approved by the Italian RINA (Registro Italiano Navale) authority.

IMO COLREG 72 Lights and Visibility - Powerboats

IMO COLREG requirements for navigation lighting on powerboats less than 50m (165ft) LOA (Length Overall).

Note - Sailboats under motor adopt the rules for Powerboats.

Powerboats up to 7m (23ft).
Not capable of more than 7 knots

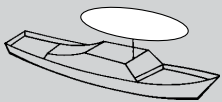

- 1x All Round White

Powerboats up to 12m (39.6ft)
Where Separate Masthead and Stern cannot be mounted



- 1x Port lamp (2 NM)
- 1x Starboard lamp (2 NM)
- OR
- 1x Bi-Colour Lamp (2NM)
- 1x All Round White lamp (2 NM)

Powerboats up to 12m (39.6ft)



- 1x Port lamp (2 NM)
- 1x Starboard lamp (2 NM)
- OR
- 1x Bi-Colour Lamp (2 NM)
- 1x Masthead lamp (2NM)
- 1x Stern lamp (2 NM)
- 1x All Round White lamp (2 NM) for vessels at anchor

Powerboats more than 12m (39.6ft), but less than 20m (66ft)



- 1x Port lamp (2 NM)
- 1x Starboard lamp (2 NM)
- OR
- 1x Bi-Colour Lamp (2 NM)
- 1x Masthead lamp (3 NM)
- 1x Stern lamp (2 NM)
- 1x All Round White lamp (2 NM) for vessels at anchor

Powerboats more than 20m (66ft), but less than 50m (165ft)



- 1x Port lamp (2 NM)
- 1x Starboard lamp (2 NM)
- 1x Masthead lamp (5 NM)
- 1x Stern lamp (2 NM)
- 1x All Round White lamp (2 NM) for vessels at anchor

The following images depict ADDITIONAL lighting requirements for specific activities:

A vessel less than 50m (165ft) engaged in trawling

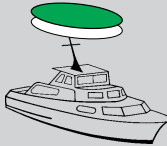

- 1x All Round Green lamp (2 NM)
- 1x All Round White lamp (2 NM)
- Mounted above one another

A vessel less than 50m (165ft) engaged in fishing, other than trawling

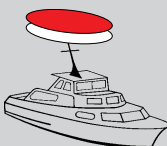

- 1x All Round Red lamp (2 NM)
- 1x All Round White lamp (2 NM)
- Mounted above one another

Powerboats towing with a tow length of less than 200m

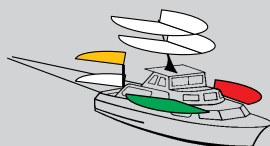

- 1x Towing lamp (2NM)
- Mounted above Stern lamp
- 2x Masthead lamps in a vertical line.
- (When the tow length exceeds 200m, 3x Masthead lamps in a vertical line)

A vessel engaged in diving operations

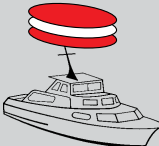

- 1x All Round Red lamp (2 NM)
- 1x All Round White lamp (2 NM)
- 1x All Round Red lamp (2 NM)
- Mounted above one another

A vessel engaged in pilotage duty

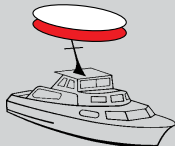

- 1x All Round White lamp (2 NM)
- 1x All Round Red lamp (2 NM)
- Mounted above one another

IMO COLREG 72 Lights and Visibility - Sailboats

IMO COLREG requirements for navigation lighting on sailboats less than 50m (165ft) LOA (Length Overall).

Note - Sailboats under motor adopt the rules for Powerboats.

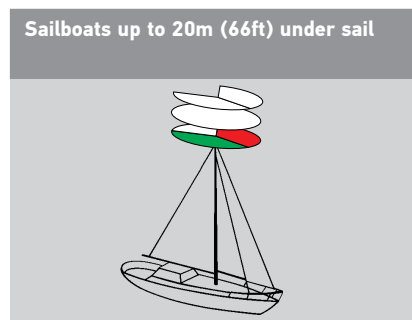

- 1x Tri-Colour lamp (2 NM)
- 1x Masthead lamp (3 NM)
- 1x All Round White lamp (2 NM) for vessels at anchor

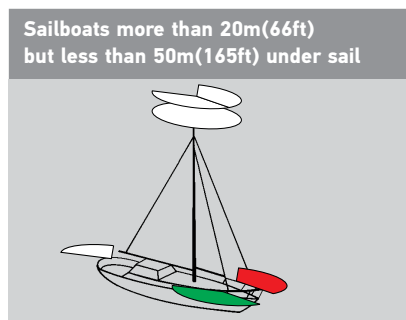

- 1x Port lamp (2 NM)
- 1x Starboard lamp (2 NM)
- OR
- 1x Bi-Colour Lamp (2 NM)
- 1x Stern lamp (2 NM)
- 1x Masthead lamp (5 NM)
- 1x All Round White lamp (2 NM) for vessels at anchor

The following images depict ADDITIONAL lighting requirements for specific activities:

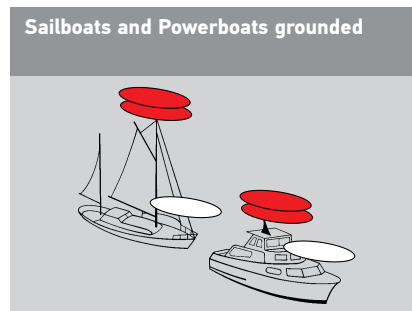

- 1x All Round White lamp (2 NM)
- 2x All Round Red lamp (2 NM) Mounted above one another

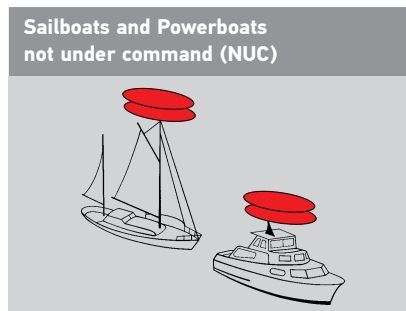

- 2x All Round Red lamp (2 NM) Mounted above one another

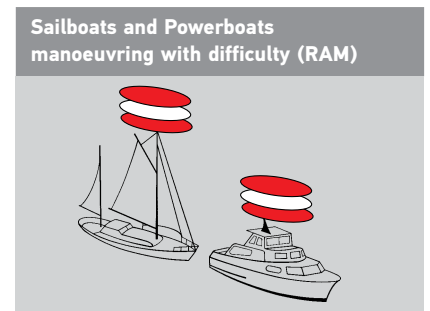

- 1x All Round Red lamp (2 NM)
- 1x All Round White lamp (2 NM)
- 1x All Round Red lamp (2 NM) Mounted above one another

APELO

Underwater Lighting Brilliance



UNDERWATER BRILLIANCE

30TH DAME
NOMINATED
2021

Hella marine redefines entertainment lighting with Apelo.
Advanced materials, optical intelligence and robotic manufacturing
combine for superior underwater brilliance. Apelo is proudly designed
and manufactured in New Zealand and backed by a 5 year warranty.



www.apelobrilliance.com



facebook.com/hellamarine
youtube.com/user/hellamarine

instagram.com/hellamarineglobal
linkedin.com/company/hella-marine

Austria
Ascherl Botzbehör
Hard (Bregenz)
Tel: +43 557489900-0
office@ascherl.at
www.ascherl.at

Croatia
M.A.G.-D.D d.o.o.
Šibenik
Tel: +385 22 337-177
info@magdd.hr
www.magdd.hr

Denmark
Hella A/S
Aabenraa
Tel: +45 73 30 36 11
michael.simsen@hella.dk
www.hellamarine.com

England
ASAP Supplies
Beccles, Suffolk
Tel: +44 (0) 1502 716993
sales@asap-supplies.com
www.asap-supplies.com

Furneaux Riddall
Portsmouth
Tel: +44 23 9266 8621
sales@furneauxriddall.com
www.furneauxriddall.com

Western Electrical
Plymouth
Tel: +44 (0)1752 484290
sales@eel.co.uk
www.westernmarinesales.co.uk

Estonia
KGK Knutsson AS
Tallinn
Tel: +372 651 9300
kgk@kgk.ee

France
Hella France
Le Blanc Mesnil
Tel: +33 1 49 39 59 59
Fax: +33 1 49 39 59 06
hellamarine.france@hella.com
www.hellamarine.com

VDM Reya
La Garde
Tel: +33 (0)7 63 95 73 35
Fax: +33 (0)4 94 08 77 79
b.massard@vdm-reya.com
www.vdm-reya.com

Finland
OY Maritim AB
Helsinki
Tel: +358-207-652705
Fax: +358-207-652-945
info@maritimshops.fi
www.Maritim.Fi

Germany
Hella GmbH & Co. KG
Lippstadt
Tel: +49 2941-386644
rita.mueller@hella.com
www.hellamarine.com

Bukh Bremen
Bremen
Tel: +49(0)421-53507-0
info@bukh-bremen.de
www.bukh-bremen.de

Robert Lindemann KG
Wendenstraße 455
D-20537 Hamburg
Telefon: 040 - 21 11 97 - 0
Telefax: 040 - 21 11 97 - 30
Email: info@lindemann-kg.de

Greece
D. Koronakis S.A.
18545 Piraeus
Tel: +30 (0)210 4060600
marine@koronakis.gr
www.koronakis.gr

Nautilus Yacht Equipment S.A.
55132 Thessaloniki
Tel: +30 (0)210 9855300
info@nautilus.gr
www.nautilus.gr

Italy
Forniture Nautiche Italiane
Cecina
Tel: +39 0586 662424
info@fni.it
www.fni.it

Latvia
KGK Knutsson SIA
Mārupe
Tel: +371 26 499 811
kgk@kgk.lv
www.kgk.lv

Netherlands
HELLA Marine Europe
3439 NC Nieuwegein
M: +31 (0)6-51336164
rene.van.miltenburg@hella.com
www.hellamarine.com

Exalto
Hardinxveld- Giessendam
Tel: +31 184615800
sales@exalto.com
www.exalto.com

Allpa
Nijmegen
Tel: +31 243777773
info@allpa.nl
www.Allpa.nl

Combi Noord
Grou
Tel: +31 566 620909
info@combinoord.nl
www.combinoord.nl

Norway
NDS - Nordic Distribution
& Service
Skytta
Tel: +47 67 06 60 00
Fax: +47 67 06 60 10
marine@nds-group.no
www.nds-group.no

Norway Marine Supply AS
Arendal
Tel: +47 37 00 03 50
salg@nmsproff.no
www.nmsproff.no

Poland
Eljacht
Gdansk
Tel: +48 583207024
info@eljacht.pl
www.eljacht.pl

Portugal
Nautiradar
Lisboa
Tel: +351 213005050
commercial@nautiradar.pt
www.nautiradar.pt

Slovenia
Stal Mar d.o.o.
Ljubljana
Tel: +386 14233540
info@stal.si
www.stalmar.si

Spain
Imnasa
Girona
Tel: +34 90210334
info@imnasa.com
www.imnasa.com

Sweden
KGK Knutsson AB
Stockholm
Tel: +46 (0)8-92 30 00
Support@kgk.se
www.marinkatalogen.se

Turkey
MARİTEK DENİZ VE YAT
MALZEMELERİ TİC. A.Ş.
İstanbul
Tel: +90 216 317 1010
aytug@marintek.com.tr
www.marintek.com